

# CooperTools

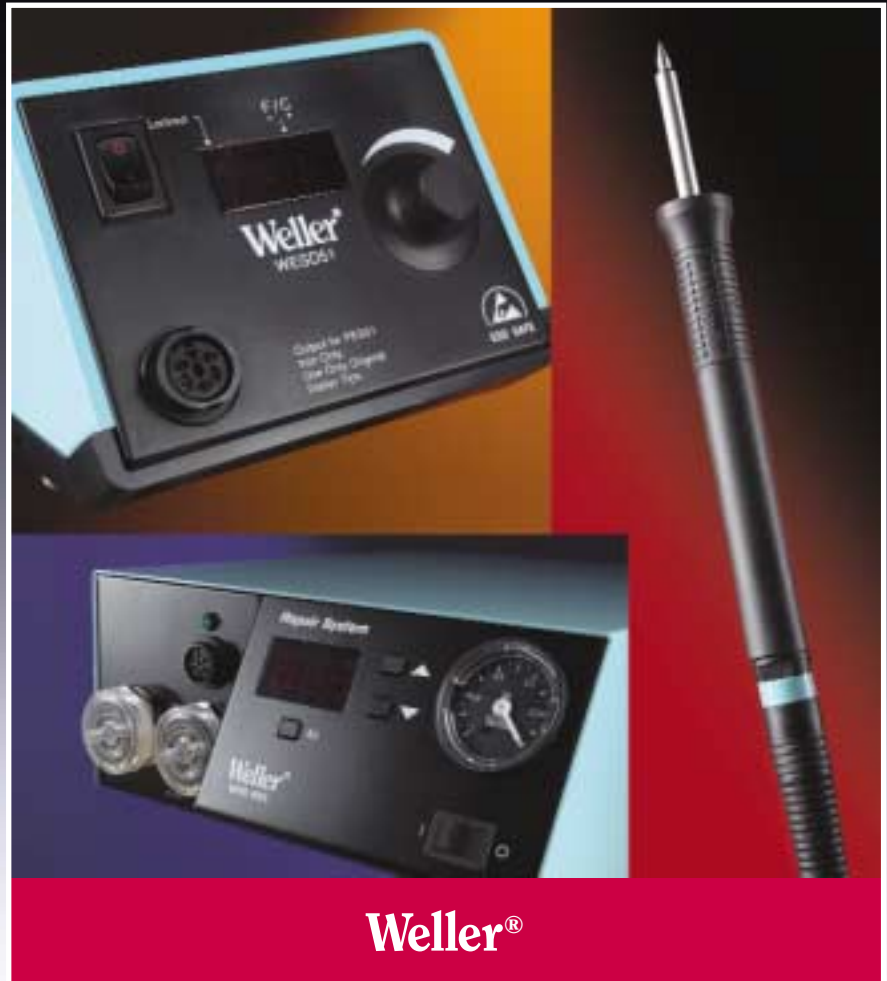

**ELECTRONIC SOLDERING AND  
DESOLDERING TOOLS**

**COOPER** Tools

## Weller® Soldering Table of Contents

Founded in 1945, Weller® has become the world's leading supplier of professional quality soldering equipment, including the famous Weller® temperature controlled irons and soldering guns. Weller® also makes advanced soldering and desoldering stations, SMT equipment and irons for sophisticated industrial requirements, plus a series of handy soldering kits for home craftsmen, hobbyists and light industry.

| Contents  | Page No. |
|---|----------|
| WES Series Soldering Stations                   | 3 - 4    |
| WSL Series Soldering Stations                   | 6        |
| WSD81 & WSD161 Silver Series Soldering Stations | 8        |
| MT1500 Microtouch™ Soldering Station            | 10       |
| WTCPT Temperature Controlled Soldering Station  | 12       |
| Desoldering Stations, Shop Air                  | 14       |
| Desoldering Stations, Self-contained            | 15       |
| Soldering/Desoldering Stations, Self-contained  | 16       |
| WRS Series Rework and Repair Systems            | 17 - 20  |
| WQB3000 BGA/QFP Rework Station                  | 22       |
| Hot Air Stations, Shop Air                      | 24       |
| Hot Air Stations, Self-contained                | 25 - 27  |
| ET Series Tips                                  | 5        |
| NT Series Tips                                  | 7        |
| LT Series Tips                                  | 9        |
| MT Series Tips                                  | 11       |
| PT Series Tips                                  | 13       |
| WT Series Tips                                  | 21       |
| DS Series Tiplets                               | 16       |
| Nozzles for Hot Air Pencils                     | 21       |
| Nozzles and Templates WQB3000                   | 23       |
| Nozzles for WHA500 and WHA2000                  | 28       |
| Weller Numerical Index                          | 29       |



# WES51 Analog Soldering Station



**The Weller Advantage**

- Innovative heater and sensor combination gives you quick heat-up and rapid temperature recovery
- Wireless temperature lockout to prevent operators from raising the temperature to levels higher than specified for the board or component. Gives you control over the process
- Station automatically powers down after 90 minutes of inactivity to prolong tip life and save power



**WES51** includes: *WES51PU* power unit, *PES51* soldering pencil with *ETA* tip, and *PH50* stand and sponge.

**Additional Product Features and Benefits:**

- **IMPROVED** plug on the *PES51* iron and new receptacle on the *WES51PU* power unit for easier iron replacement
- Designed for continuous production soldering
- Slim, comfortable pencil reduces operator fatigue
- Tip temperature offset capability which provides the user with the capability of resetting station temperature readings to match in tip sizes and styles
- Iron is fitted with a non-burnable silicon rubber cord for safety
- UL and cUL listed
- ESD safe to protect sensitive components
- Use ET series tips found on page 5

| Station               | WES51                                  | Pencil               | PES51  |
|-----------------------|--|----------------------|--|
| Voltage               | 120V (input); 24V (output)             | Power Consumption    | 50W  |
| Temperature Range     | 350°F - 850°F (177°C - 454°C)          | Heating Element Type | Nichrome Wound; Fiberglass and ceramic insulated |
| Footprint             | 5.9 X 4.5 X 3.6 IN (150 X 114 X 91 MM) | Iron Cord Length     | 4 ft. (1.22 m)                                   |
| Weight                | 3.93 lb. (1.78 kg)                     | Supplied Tip         | ETA  |
| Temperature Accuracy  | +/- 9°F (+/-5°C)                       | Iron Stand           | PH50   |
| Temperature Stability | +/-10°F (6°C)                          |                      |  |
| ESD Safe?             | Yes                                    |                      |  |

**Applications:**

- Production, rework, and repair of through hole and SMT boards. Most ground planes and multi-layer boards.



The *PES51* is perfect for production soldering, rework, or repair.



The new connector and plug on the *WES51* is an improvement over the *WES50*

# WESD51 Digital Soldering Station



WESD51PU



PH50

PES51

**WESD51** includes: *WESD51PU* power unit, *PES51* soldering pencil with *ETA* tip, and *PH50* stand and sponge.

## The Weller Advantage

- Innovative heater and sensor combination gives you quick heat-up and rapid temperature recovery
- Wireless temperature lockout to prevent operators from raising the temperature to levels higher than specified for the board or component. Gives you control over the process
- Station automatically powers down after 90 minutes of inactivity to prolong tip life and save power

### Additional Product Features and Benefits:

- Microprocessor controlled with digital LED display allows you to read temperature setting and actual tip temperature
- Designed for continuous production soldering
- Can switch between °F and °C
- Slim, comfortable pencil reduces operator fatigue
- Tip temperature offset capability which provides the user with the capability of resetting station temperature readings to match in tip sizes and styles
- Iron is fitted with a non-burnable silicon rubber cord for safety
- UL and cUL listed
- ESD safe to protect sensitive components
- Use ET series tips found on page 5

| Station               | WESD51                                 | Pencil               | PES51  |
|-----------------------|--|----------------------|--|
| Voltage               | 120V (input); 24V (output)             | Power Consumption    | 50W  |
| Temperature Range     | 350°F - 850°F (177°C - 454°C)          | Heating Element Type | Nichrome Wound; Fiberglass and ceramic insulated |
| Footprint             | 5.9 X 4.5 X 3.6 IN (150 X 114 X 91 MM) | Iron Cord Length     | 4 ft. (1.22 m)                                   |
| Weight                | 3.93 lb. (1.78 kg)                     | Supplied Tip         | ETA  |
| Temperature Accuracy  | +/- 9°F (+/-5°C)                       | Iron Stand           | PH50   |
| Temperature Stability | +/-10°F (6°C)                          |                      |  |
| ESD Safe?             | Yes                                    |                      |  |

### Applications:

- Production, rework, and repair of through hole and SMT boards. Most ground planes and multi-layer boards.



The PES51 can handle most general purpose hand soldering applications.



The wireless temperature lockout gives you control over the process.

# ET Series Tips for PES51 Soldering Pencil

## The Weller Advantage

- The sensor hole in the base of the tip is fitted with a stainless steel liner to prevent the tip from seizing to the sensor

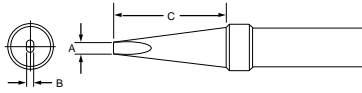

Screwdriver

| Cat. No. | A     |      | B     |      | C     |       |
|----------|-------|------|-------|------|-------|-------|
|          | in.   | mm   | in.   | mm   | in.   | mm    |
| ETA*     | 0.062 | 1.60 | 0.032 | 0.81 | 0.625 | 15.90 |
| ETB*     | 0.093 | 2.40 | 0.020 | 0.51 | 0.625 | 15.90 |
| ETC*     | 0.125 | 3.20 | 0.027 | 0.69 | 0.625 | 15.90 |
| ETD      | 0.187 | 4.80 | 0.035 | 0.89 | 0.625 | 15.90 |
| ETH      | 0.031 | 0.80 | 0.019 | 0.48 | 0.625 | 15.90 |

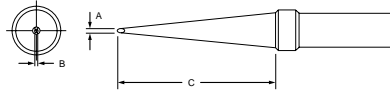

Long Screwdriver

| Cat. No. | A     |      | B     |      | C     |       |
|----------|-------|------|-------|------|-------|-------|
|          | in.   | mm   | in.   | mm   | in.   | mm    |
| ETJ      | 0.031 | 0.80 | 0.012 | 0.30 | 1.000 | 25.40 |
| ETK*     | 0.046 | 1.20 | 0.026 | 0.66 | 1.000 | 25.40 |
| ETL      | 0.078 | 2.00 | 0.027 | 0.69 | 1.000 | 25.40 |
| ETM      | 0.125 | 3.20 | 0.037 | 0.94 | 1.000 | 25.40 |

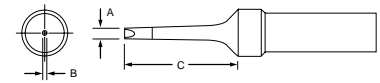

Narrow Screwdriver

| Cat. No. | A     |      | B     |      | C     |       |
|----------|-------|------|-------|------|-------|-------|
|          | in.   | mm   | in.   | mm   | in.   | mm    |
| ETR      | 0.062 | 1.60 | 0.044 | 1.12 | 0.625 | 15.90 |

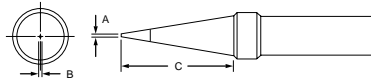

Conical

| Cat. No. | A     |      | B     |      | C     |       |
|----------|-------|------|-------|------|-------|-------|
|          | in.   | mm   | in.   | mm   | in.   | mm    |
| ETP*     | 0.031 | 0.80 | 0.012 | 0.30 | 0.625 | 15.90 |
| ETT      | 0.024 | 0.60 | 0.036 | 0.91 | 0.625 | 15.90 |

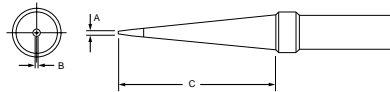

Long Conical

| Cat. No. | A     |      | B     |      | C     |       |
|----------|-------|------|-------|------|-------|-------|
|          | in.   | mm   | in.   | mm   | in.   | mm    |
| ETO*     | 0.031 | 0.80 | 0.044 | 1.12 | 1.000 | 25.40 |
| ETS*     | 0.015 | 0.40 | --    | --   | 1.000 | 25.40 |

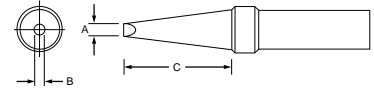

Single Flat

| Cat. No. | A     |      | B     |      | C     |       |
|----------|-------|------|-------|------|-------|-------|
|          | in.   | mm   | in.   | mm   | in.   | mm    |
| ETAA     | 0.062 | 1.60 | 0.040 | 1.02 | 0.625 | 15.90 |
| ETBB     | 0.093 | 2.40 | 0.032 | 0.81 | 0.625 | 15.90 |
| ETCC     | 0.125 | 3.20 | 0.032 | 0.81 | 0.625 | 15.90 |
| ETDD     | 0.187 | 4.80 | 0.032 | 0.81 | 0.625 | 15.90 |
| ETU      | 0.015 | 0.40 | --    | --   | 0.700 | 17.80 |
| ETV      | 0.024 | 0.60 | --    | --   | 0.700 | 17.80 |

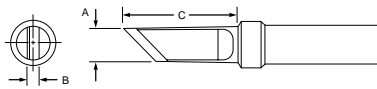

Knife

| Cat. No. | A     |      | B     |      | C     |       |
|----------|-------|------|-------|------|-------|-------|
|          | in.   | mm   | in.   | mm   | in.   | mm    |
| ETKN     | 0.180 | 4.57 | 0.064 | 1.63 | 0.625 | 15.90 |

\* Indicates available bulk (100 multiples only)

# WSL/WSL2 Digital Soldering Station with WMP Micro Soldering Pencil



**WSL** includes: *WSLPU* power unit, *WMP* soldering pencil, and *WMPH* stand and sponge.

### The Weller Advantage

- The heating element is contained in the pencil rather than the tip so you don't throw away a good heater every time you wear out a tip. **Gives you substantial savings on tip costs compared to the competition**
- Micro soldering pencil with the shortest tip-to-grip distance (37mm) on the market today gives you excellent control and puts you closer to the work



**WSL2** includes: *WSL2PU* power unit, *WMP* soldering pencil, *WMPH* stand and sponge, *WSP80* soldering pencil *WHP81* stand and sponge.

Additional Product Features and Benefits:

- Super-fast heat-up saves you time
- Superior thermal recovery allows fast, efficient soldering
- Tips are secured to the pencil by use of a threaded end, which eliminates the need for a barrel nut
- Iron is fitted with a non-burnable silicone rubber cord for safety
- The standard setback feature saves tip life and power. If the soldering pencil is not used for 20 minutes, the temperature is reduced to 300°F (150°C). After 60 minutes of inactivity, the unit is switched off
- The station's display is programmable using the optional WCB1 control module. Allows you to set temperature lock-out, set-back, and °F to °C switching
- Stations also support the WTA50 Thermal Tweezer, WHP80 Hot Plate, and WST20 Thermal Wire Stripper
- ESD safe to protect sensitive components
- UL and cUL listed
- Use new NT series tips found on page 7

| Station               | WSL and WSL2                              | Pencil               | WMP            | WSP80          |
|-----------------------|---|----------------------|----------------|----------------|
| Voltage               | 120V (input); 24V (output)                | Power Consumption    | 65W            | 80W            |
| Power Consumption     | 95W                                       | Heating Element Type | Nichrome Wound | Silver Spool   |
| Temperature Range     | 150°F - 850°F (66°C - 454°C)              | Iron Cord Length     | 4 ft. (1.22 m) | 4 ft. (1.22 m) |
| Footprint             | 6 1/2 X 4 1/2 X 4 IN (165 X 114 X 102 MM) | Supplied Tip         | NT1            | LTB            |
| Weight                | 7.0 lb. (3.18 kg)                         | Iron Stand           | WMPH           | WPH81          |
| Temperature Accuracy  | +/- 9°F (+/-5°C)                          |                      |                |                |
| Temperature Stability | +/-10°F (6°C)                             |                      |                |                |
| ESD Safe?             | Yes                                       |                      |                |                |

Applications:

- Production, rework, and repair of through hole and SMT boards. Contact removal of IC's and QFP's using specialty SMT tips. Lead-free solder applications. Most ground planes and multi-layered boards.



The short (37mm) tip-to-grip distance puts you close to the work.



A SMT blade tip is ideal for soldering the leads of a QFP.



The heater is integrated into the handle. When the tip dies, the heater lives on.

# NT Series Tips for WMP Micro Soldering Pencil

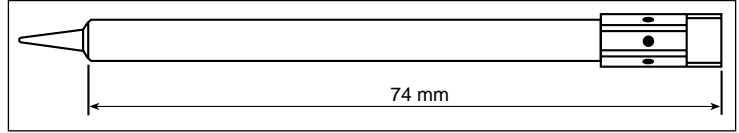

**The Weller Advantage**

- The heating element is contained in the pencil rather than the tip so you don't throw away a good heater every time you wear out a tip
- Gives you substantial savings on tip costs compared to the competition

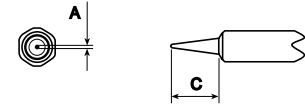

Micro

| Cat. No. | A     |      | B   |    | C     |      |
|----------|-------|------|-----|----|-------|------|
|          | in.   | mm   | in. | mm | in.   | mm   |
| NT1      | 0.010 | 0.25 | --  | -- | 0.291 | 7.40 |
| NT1S     | 0.010 | 0.25 | --  | -- | 0.333 | 8.45 |

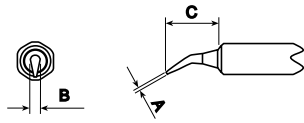

Bent Round

| Cat. No. | A     |      | B     |      | C     |      |
|----------|-------|------|-------|------|-------|------|
|          | in.   | mm   | in.   | mm   | in.   | mm   |
| NT1X     | 0.016 | 0.40 | 0.063 | 1.60 | 0.321 | 8.15 |

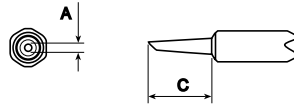

Round

| Cat. No. | A     |      | B   |    | C     |      |
|----------|-------|------|-----|----|-------|------|
|          | in.   | mm   | in. | mm | in.   | mm   |
| NT4      | 0.047 | 1.20 | --  | -- | 0.390 | 9.90 |

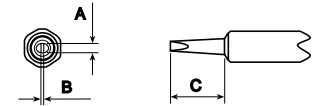

Chisel

| Cat. No. | A     |      | B     |      | C     |      |
|----------|-------|------|-------|------|-------|------|
|          | in.   | mm   | in.   | mm   | in.   | mm   |
| NT6      | 0.063 | 1.60 | 0.016 | 0.40 | 0.372 | 9.45 |
| NTA      | 0.063 | 1.60 | 0.016 | 0.40 | 0.331 | 8.40 |
| NTB      | 0.094 | 2.40 | 0.031 | 0.80 | 0.289 | 7.35 |
| NTC      | 0.126 | 3.20 | 0.031 | 0.80 | 0.305 | 7.75 |
| NTD      | 0.157 | 4.00 | 0.031 | 0.80 | 0.305 | 7.75 |
| NTH      | 0.031 | 0.80 | 0.016 | 0.40 | 0.331 | 8.40 |
| NTK      | 0.047 | 1.20 | 0.016 | 0.40 | 0.331 | 8.40 |

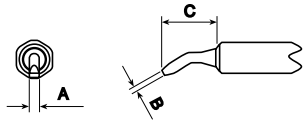

Bent Chisel

| Cat. No. | A     |      | B     |      | C     |      |
|----------|-------|------|-------|------|-------|------|
|          | in.   | mm   | in.   | mm   | in.   | mm   |
| NTAX     | 0.063 | 1.60 | 0.031 | 0.80 | 0.339 | 8.61 |

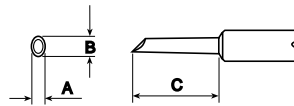

Cylindrical

| Cat. No. | A     |      | B     |      | C     |       |
|----------|-------|------|-------|------|-------|-------|
|          | in.   | mm   | in.   | mm   | in.   | mm    |
| NTGW     | 0.079 | 2.00 | 0.118 | 3.00 | 0.528 | 13.40 |

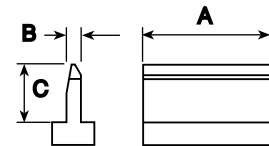

SMT Blade

| Cat. No. | A     |       | B     |      | C     |      |
|----------|-------|-------|-------|------|-------|------|
|          | in.   | mm    | in.   | mm   | in.   | mm   |
| NTSMT01  | 0.410 | 10.41 | 0.022 | 0.56 | 0.280 | 7.11 |
| NTSMT02  | 0.620 | 16.75 | 0.022 | 0.56 | 0.280 | 7.11 |
| NTSMT03  | 0.820 | 20.83 | 0.022 | 0.56 | 0.280 | 7.11 |

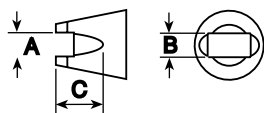

SMT Slot

| Cat. No. | A     |      | B     |      | C     |      |
|----------|-------|------|-------|------|-------|------|
|          | in.   | mm   | in.   | mm   | in.   | mm   |
| NTSMT04  | 0.070 | 1.78 | 0.195 | 4.95 | 0.070 | 1.78 |
| NTSMT05  | 0.060 | 1.52 | 0.090 | 2.29 | 0.070 | 1.78 |
| NTSMT06  | 0.100 | 2.54 | 0.068 | 1.73 | 0.055 | 1.40 |
| NTSMT07  | 0.090 | 2.29 | 0.190 | 4.53 | 0.070 | 1.78 |

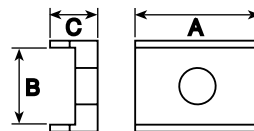

SMT Tunnel

| Cat. No. | A     |       | B     |      | C     |      |
|----------|-------|-------|-------|------|-------|------|
|          | in.   | mm    | in.   | mm   | in.   | mm   |
| NTSMT08  | 0.180 | 4.57  | 0.200 | 5.08 | 0.090 | 2.29 |
| NTSMT09  | 0.410 | 10.41 | 0.200 | 5.08 | 0.090 | 2.29 |
| NTSMT10  | 0.450 | 11.49 | 0.270 | 6.86 | 0.090 | 2.29 |
| NTSMT11  | 0.520 | 13.21 | 0.375 | 9.53 | 0.125 | 3.18 |
| NTSMT12  | 0.620 | 15.75 | 0.375 | 9.53 | 0.125 | 3.18 |
| NTSMT13  | 0.720 | 18.27 | 0.375 | 9.53 | 0.125 | 3.18 |
| NTSMT14  | 0.740 | 18.80 | 0.365 | 9.02 | 0.125 | 3.18 |

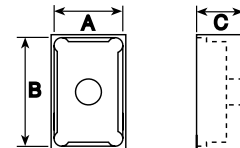

SMT Quad

| Cat. No. | A     |       | B     |       | C     |      |
|----------|-------|-------|-------|-------|-------|------|
|          | in.   | mm    | in.   | mm    | in.   | mm   |
| NTSMT15  | 0.105 | 2.67  | 0.303 | 7.70  | 0.150 | 3.81 |
| NTSMT16  | 0.410 | 10.41 | 0.410 | 10.41 | 0.150 | 3.81 |
| NTSMT17  | 0.500 | 12.70 | 0.500 | 12.70 | 0.150 | 3.81 |
| NTSMT18  | 0.540 | 13.72 | 0.340 | 8.60  | 0.150 | 3.81 |
| NTSMT19  | 0.750 | 19.05 | 0.750 | 19.05 | 2.350 | 5.96 |
| NTSMT20  | 0.915 | 23.24 | 0.680 | 17.27 | 0.150 | 3.81 |
| NTSMT21  | 0.965 | 24.51 | 0.965 | 24.51 | 2.350 | 5.96 |
| NTSMT22  | 1.155 | 29.59 | 1.165 | 29.59 | 2.350 | 5.96 |

# WSD81/WSD161 Digital Silver Series Soldering Stations



**WSD81** includes: *WSD81PU* power unit, *WSP80* soldering pencil, and *WPH81* stand and sponge.

## The Weller Advantage

- You experience immediate heat from the combination of a unique silver heating element and tip configuration - allows faster, more efficient, soldering
- High output pencil allows you to work with lead-free solder while keeping tip costs low
- The WSD161 operates on two independently controlled channels. You can operate two 80-watt tools simultaneously



**WSD161** includes the power unit only. Soldering pencils and stands are sold separately.

### Additional Product Features and Benefits:

- **IMPROVED** - Software has been upgraded to allow the power unit to cycle faster, giving you improved response time
- **IMPROVED** - A standard setback feature has been added to save tip life and power. If the soldering pencil is not used for 20 minutes, the temperature is reduced to 300°F (150°C). After 60 minutes of inactivity, the unit is switched off
- 80-watts of controlled power allows you to work on high-mass components and boards
- Fast recovery and minimal temperature loss when making fast connections, makes this station perfect for continuous production soldering
- Programmable using the optional WCB1 control module - allows for temperature lock-out (process control), temperature set-back (extended tip life) and °F to °C conversion
- Irons fitted with a non-burnable silicone rubber cord for safety
- UL and cUL listed
- ESD safe to protect sensitive components
- Uses economical LT series tips (page 9), which are now tinned using LEAD-FREE SOLDER to comply with changing demands
- Stations also support the WTA50 Thermal Tweezer, WHP80 Hot Plate, and WST20 Thermal Wire Stripper

| Station               | WSD81                                     | WSD161                                    | Pencil               | WSP80          |
|-----------------------|---|---|----------------------|----------------|
| Voltage               | 120V (input); 24V (output)                | 120V (input); 24V (output)                | Power Consumption    | 80W            |
| Power Consumption     | 95W                                       | 150W                                      | Heating Element Type | Silver Spool   |
| Temperature Range     | 150°F - 850°F (66°C - 454°C)              | 300°F - 850°F (150°C - 454°C)             | Iron Cord Length     | 4 ft. (1.22 m) |
| Footprint             | 6 1/2 X 4 1/2 X 4 IN (165 X 114 X 102 CM) | 6 1/2 X 4 1/2 X 4 IN (165 X 114 X 102 MM) | Supplied Tip         | LTB            |
| Weight                | 7.0 lb. (3.18 kg)                         | 7.0 lb. (3.18 kg)                         | Iron Stand           | WPH81          |
| Temperature Accuracy  | +/- 9°F (+/-5°C)                          | +/- 9°F (+/-5°C)                          |                      |                |
| Temperature Stability | +/-10°F (6°C)                             | +/-10°F (6°C)                             |                      |                |
| ESD Safe?             | Yes                                       | Yes                                       |                      |                |

### Applications:

- Production, rework, and repair of through hole and SMT boards. Contact removal of IC's and QFP's using specialty SMT tips. Lead-free solder applications. Heavy ground planes and multi-layered boards.



The WSP80 in use on a surface mount PCB.



The WCB1 control module is used to set temperature lockout, set back, and °F to °C conversion.



A SMT quad tip is used to desolder a quad flat pack.



# LT Series Tips for WSP80 Soldering Pencil

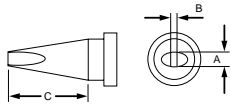

Chisel

| Cat. No. | A     |      | B     |      | C     |       |
|----------|-------|------|-------|------|-------|-------|
|          | in.   | mm   | in.   | mm   | in.   | mm    |
| LTA      | 0.063 | 1.60 | 0.028 | 0.70 | 0.380 | 9.70  |
| LTB      | 0.094 | 2.40 | 0.031 | 0.79 | 0.430 | 10.90 |
| LTC      | 0.126 | 3.20 | 0.031 | 0.79 | 0.430 | 10.90 |
| LTD      | 0.181 | 4.60 | 0.031 | 0.79 | 0.430 | 10.90 |
| LTH      | 0.031 | 0.79 | 0.016 | 0.40 | 0.430 | 10.90 |
| LTK      | 0.047 | 1.20 | 0.016 | 0.40 | 0.730 | 18.50 |
| LTL      | 0.039 | 1.00 | 0.039 | 1.00 | 0.790 | 20.00 |
| LTM      | 0.126 | 3.20 | 0.047 | 1.20 | 0.790 | 20.00 |

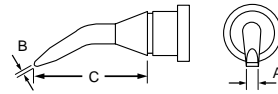

Bent Chisel

| Cat. No. | A     |      | B     |      | C     |       |
|----------|-------|------|-------|------|-------|-------|
|          | in.   | mm   | in.   | mm   | in.   | mm    |
| LT4X     | 0.047 | 1.20 | 0.016 | 0.40 | 0.590 | 15.00 |
| LTAX     | 0.063 | 1.60 | 0.032 | 0.80 | 0.500 | 12.70 |
| LTHX     | 0.024 | 0.60 | 0.016 | 0.40 | 0.790 | 20.00 |

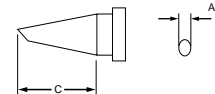

Single Flat

| Cat. No. | A     |      | B   |    | C     |       |
|----------|-------|------|-----|----|-------|-------|
|          | in.   | mm   | in. | mm | in.   | mm    |
| LT4W     | 0.047 | 1.20 | --  | -- | 0.590 | 15.00 |
| LTF      | 0.047 | 1.20 | --  | -- | 0.490 | 12.50 |

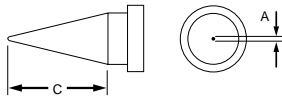

Round

| Cat. No. | A     |      | B   |    | C     |       |
|----------|-------|------|-----|----|-------|-------|
|          | in.   | mm   | in. | mm | in.   | mm    |
| LT1      | 0.010 | 0.25 | --  | -- | 0.430 | 10.90 |
| LT1L     | 0.008 | 0.20 | --  | -- | 0.980 | 25.00 |
| LT1S     | 0.016 | 0.40 | --  | -- | 0.790 | 20.00 |
| LTAS     | 0.63  | 1.60 | --  | -- | 0.380 | 9.70  |
| LTCS     | 0.126 | 3.20 | --  | -- | 0.430 | 10.90 |
| LTS      | 0.016 | 0.40 | --  | -- | 0.790 | 20.00 |

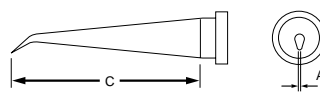

Bent Round

| Cat. No. | A     |      | B   |    | C     |       |
|----------|-------|------|-----|----|-------|-------|
|          | in.   | mm   | in. | mm | in.   | mm    |
| LT1LX    | 0.008 | 0.20 | --  | -- | 0.980 | 25.00 |
| LT1SLX   | 0.012 | 0.30 | --  | -- | 0.760 | 19.20 |
| LT1X     | 0.010 | 0.25 | --  | -- | 0.370 | 9.40  |

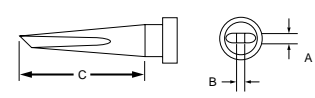

Knife

| Cat. No. | A     |      | B     |      | C     |       |
|----------|-------|------|-------|------|-------|-------|
|          | in.   | mm   | in.   | mm   | in.   | mm    |
| LTKN     | 0.059 | 1.50 | 0.033 | 0.80 | 0.730 | 18.50 |

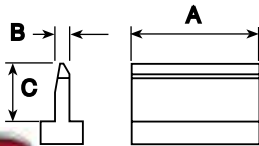

**New!** SMT Blade

| Cat. No. | A     |       | B     |      | C     |      |
|----------|-------|-------|-------|------|-------|------|
|          | in.   | mm    | in.   | mm   | in.   | mm   |
| LTSMT01  | 0.410 | 10.41 | 0.022 | 0.56 | 0.280 | 7.11 |
| LTSMT02  | 0.620 | 16.75 | 0.022 | 0.56 | 0.280 | 7.11 |
| LTSMT03  | 0.820 | 20.83 | 0.022 | 0.56 | 0.280 | 7.11 |

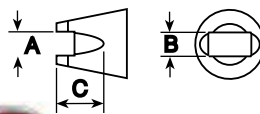

**New!** SMT Slot

| Cat. No. | A     |      | B     |      | C     |      |
|----------|-------|------|-------|------|-------|------|
|          | in.   | mm   | in.   | mm   | in.   | mm   |
| LTSMT04  | 0.070 | 1.78 | 0.195 | 4.95 | 0.070 | 1.78 |
| LTSMT05  | 0.060 | 1.52 | 0.090 | 2.29 | 0.070 | 1.78 |
| LTSMT06  | 0.100 | 2.54 | 0.068 | 1.73 | 0.055 | 1.40 |
| LTSMT07  | 0.090 | 2.29 | 0.190 | 4.53 | 0.070 | 1.78 |

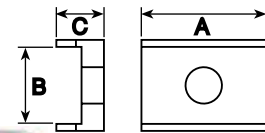

**New!** SMT Tunnel

| Cat. No. | A     |       | B     |      | C     |      |
|----------|-------|-------|-------|------|-------|------|
|          | in.   | mm    | in.   | mm   | in.   | mm   |
| LTSMT08  | 0.180 | 4.57  | 0.200 | 5.08 | 0.090 | 2.29 |
| LTSMT09  | 0.410 | 10.41 | 0.200 | 5.08 | 0.090 | 2.29 |
| LTSMT10  | 0.450 | 11.49 | 0.270 | 6.86 | 0.090 | 2.29 |
| LTSMT11  | 0.520 | 13.21 | 0.375 | 9.53 | 0.125 | 3.18 |
| LTSMT12  | 0.620 | 15.75 | 0.375 | 9.53 | 0.125 | 3.18 |
| LTSMT13  | 0.720 | 18.27 | 0.375 | 9.53 | 0.125 | 3.18 |
| LTSMT14  | 0.740 | 18.80 | 0.365 | 9.02 | 0.125 | 3.18 |

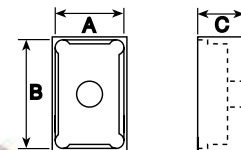

**New!** SMT Quad

| Cat. No. | A     |       | B     |       | C     |      |
|----------|-------|-------|-------|-------|-------|------|
|          | in.   | mm    | in.   | mm    | in.   | mm   |
| LTSMT15  | 0.105 | 2.67  | 0.303 | 7.70  | 0.150 | 3.81 |
| LTSMT16  | 0.410 | 10.41 | 0.410 | 10.41 | 0.150 | 3.81 |
| LTSMT17  | 0.500 | 12.70 | 0.500 | 12.70 | 0.150 | 3.81 |
| LTSMT18  | 0.540 | 13.72 | 0.340 | 8.60  | 0.150 | 3.81 |
| LTSMT19  | 0.750 | 19.05 | 0.750 | 19.05 | 2.350 | 5.96 |
| LTSMT20  | 0.915 | 23.24 | 0.680 | 17.27 | 0.150 | 3.81 |
| LTSMT21  | 0.965 | 24.51 | 0.965 | 24.51 | 2.350 | 5.96 |
| LTSMT22  | 1.155 | 29.59 | 1.165 | 29.59 | 2.350 | 5.96 |

# MT1500 Microtouch™ Soldering Station



### The Weller Advantage

- An integrated heater and tip design gives you immediate heat for faster soldering. Heats up to set temperature in as little as 3 seconds
- The Touch Mode extends tip life and reduces operating costs by automatically powering down the pencil upon placing in the stand, and quickly adjusts to set temperature when the handle is touched again
- Unconditional five year warranty on the station and hand piece to ensure your complete satisfaction

**MT1500** includes: *MT1501* soldering pencil (no tip), and *MT1502* stand, and leather tip-changing pad.

**Additional Product Features and Benefits:**

- Quick tip change system requires no tools, saves you time and money
- Superior thermal recovery improves performance in all applications
- Three operating modes increases flexibility:
  - Continuous - tip stays at set temperature until turned off
  - Idle - station automatically sets back the temperature too 400°F (204°C) after 1 minute of inactivity
  - Touch Mode - station automatically powers the tool down upon release of handle and almost instantly adjusts to desired temperature when handle is touched again
- Iron is fitted with a non-burnable silicon rubber cord for safety
- UL and cUL listed
- ESD safe to protect sensitive components
- Use MT series tips found on page 11

| Station               | MT1500  | Pencil           | PES51            |
|-----------------------|---|------------------|------------------|
| Voltage               | 120V (input); 24V/12V/6V (output) **            | Iron Cord Length | 4 ft. (1.22 m)   |
| Power Consumption     | 150W  | Supplied Tip     | Tip Not Included |
| Temperature Range     | 400°F - 800°F (204°C - 454°C)                   | Iron Stand       | MT1502           |
| Footprint             | 6 5/8 X 4 1/8 X 3 7/8 IN (16.8 X 20.6 X 9.8 CM) |                  |                  |
| Weight                | 8.2 lb. (3.72 kg)                               |                  |                  |
| Temperature Accuracy  | +/- 9°F (6°C)                                   |                  |                  |
| Temperature Stability | +/-10°F (6°C)                                   |                  |                  |
| ESD Safe?             | Yes   |                  |                  |

\*\* Tip Specific

**Applications:**

- Production, rework, and repair of through hole and SMT boards. Lead-free solder applications. Heavy ground planes and multi-layer boards.



The MT1500 can handle the most demanding applications.



The MT1500 soldering pencil at work on a SMT component.

# MT Series Tips for MT1501 Soldering Pencil

### Tip Dimension Legend:

- A = Tip Diameter
- B = Tip Thickness
- C = Tip Reach

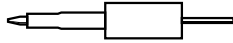

Screwdriver

| Cat. No. | A     |      | B     |      | C    |       |
|----------|-------|------|-------|------|------|-------|
|          | in.   | mm   | in.   | mm   | in.  | mm    |
| MT211    | 0.045 | 1.14 | 0.015 | 0.38 | 1.00 | 25.40 |
| MT212*   | 0.045 | 1.14 | 0.015 | 0.38 | 1.00 | 25.40 |
| MT301    | 0.047 | 1.19 | 0.015 | 0.38 | 0.02 | 0.51  |
| MT604    | 0.060 | 1.52 | 0.025 | 0.64 | 0.39 | 9.78  |
| MT601    | 0.070 | 1.78 | 0.023 | 0.58 | 0.39 | 9.78  |
| MT602    | 0.100 | 2.54 | 0.030 | 0.76 | 0.39 | 9.78  |
| MT610    | 0.200 | 5.08 | 0.030 | 0.76 | 0.35 | 8.89  |

\* Non-wetting

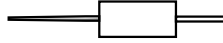

Conical

| Cat. No. | A     |      | B   |    | C    |       |
|----------|-------|------|-----|----|------|-------|
|          | in.   | mm   | in. | mm | in.  | mm    |
| MT302    | 0.015 | 0.38 | --  | -- | 0.02 | 0.51  |
| MT303    | 0.015 | 0.38 | --  | -- | 0.32 | 8.13  |
| MT606    | 0.016 | 0.41 | --  | -- | 0.53 | 13.46 |
| MT613    | 0.020 | 0.51 | --  | -- | 0.52 | 13.21 |
| MT609    | 0.023 | 0.58 | --  | -- | 0.60 | 15.24 |
| MT202    | 0.030 | 0.76 | --  | -- | 1.00 | 25.40 |
| MT203†   | 0.030 | 0.76 | --  | -- | 1.00 | 25.40 |
| MT204*   | 0.030 | 0.76 | --  | -- | 1.00 | 25.40 |

\* Non-wetting  
† Mil-Spec

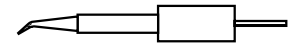

Bent Conical

| Cat. No. | A     |      | B   |    | C    |       |
|----------|-------|------|-----|----|------|-------|
|          | in.   | mm   | in. | mm | in.  | mm    |
| MT605    | 0.016 | 0.41 | --  | -- | 0.56 | 14.22 |
| MT603    | 0.020 | 0.51 | --  | -- | 0.60 | 15.24 |

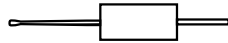

Chisel

| Cat. No. | A     |      | B     |      | C    |       |
|----------|-------|------|-------|------|------|-------|
|          | in.   | mm   | in.   | mm   | in.  | mm    |
| MT611    | 0.060 | 1.52 | 0.010 | 0.25 | 0.61 | 15.49 |
| MT614    | 0.100 | 2.54 | 0.015 | 0.38 | 0.19 | 4.38  |

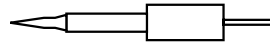

Bevel

| Cat. No. | A     |      | B     |      | C    |       |
|----------|-------|------|-------|------|------|-------|
|          | in.   | mm   | in.   | mm   | in.  | mm    |
| MT607    | 0.020 | 0.51 | 0.010 | 0.25 | 0.53 | 13.50 |
| MT608    | 0.040 | 1.02 | 0.020 | 0.51 | 0.56 | 14.22 |

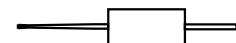

Micro

| Cat. No. | A     |      | B   |    | C    |       |
|----------|-------|------|-----|----|------|-------|
|          | in.   | mm   | in. | mm | in.  | mm    |
| MT221    | 0.031 | 0.79 | --  | -- | 1.00 | 25.40 |

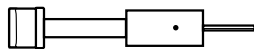

SMT Blade

| Cat. No. | A     |       | B     |      | C    |      |
|----------|-------|-------|-------|------|------|------|
|          | in.   | mm    | in.   | mm   | in.  | mm   |
| MT617    | 0.410 | 10.41 | 0.022 | 0.56 | 0.28 | 7.11 |
| MT1205   | 0.820 | 20.83 | 0.022 | 0.56 | 0.28 | 7.11 |

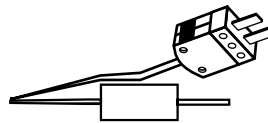

Calibration

| Cat. No. | A     |      | B     |      | C    |      |
|----------|-------|------|-------|------|------|------|
|          | in.   | mm   | in.   | mm   | in.  | mm   |
| MT220    | 0.030 | 0.76 | --    | --   | --   | --   |
| MT620    | 0.063 | 1.59 | 0.023 | 0.58 | 0.39 | 9.78 |

# WTCPT Temperature Controlled Soldering Station



**The Weller Advantage**

- Utilizes unique closed loop method of controlling maximum tip temperature - protects temperature sensitive components
- A ferromagnetic temperature sensor in the tip controls tip temperature - no adjustments are necessary. Provides process control

**WTCPT** includes: *PU120T* power unit, *TC201T* soldering pencil, and *PH1201ESD* stand and sponge.

**Applications:**

- Production, rework, and repair of through hole and SMT boards. Some ground planes and multi-layer boards. Repetitive soldering at a consistent temperature.

**Additional Product Features and Benefits:**

- A lighted rocker switch indicates on/off status
- Quick disconnect plug for soldering iron allows fast iron change
- PT series tips are available in three standard temperature ranges: 600°F, 700°F, 800°F. See page 13
- Power unit features impact resistant plastic for durability
- ESD safe to protect sensitive components
- UL and cUL listed

| Station           | WTCPT   | Pencil               | TC201T                  |
|-------------------|---|----------------------|-------------------------|
| Voltage           | 120V (input); 24V (output)                    | Power Consumption    | 42W                     |
| Power Consumption | 60W   | Heating Element Type | Nichrome Wound, Plug-in |
| Temperature Range | 600°F - 800°F (316°C - 427°C)                 | Iron Cord Length     | 4 ft. (1.22 m)          |
| Footprint         | 4 1/2 X 5 15/16 X 3 5/8 IN (114 X 150 X 91MM) | Supplied Tip         | PTA7                    |
| Weight            | 3.9 lb. (1.78 kg)                             | Iron Stand           | PH1201ESD               |
| ESD Safe?         | Yes   |                      |                         |

# PT Series Tips for TC201T Soldering Pencil

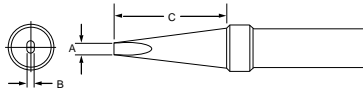

Screwdriver

| Cat. No. | Cat. No. | Cat. No. | A     |      | B     |      | C    |       |
|----------|----------|----------|-------|------|-------|------|------|-------|
|          |          |          | in.   | mm   | in.   | mm   | in.  | mm    |
| 600°     | 700°     | 800°     |       |      |       |      |      |       |
| PTH6     | PTH7     | PTH8     | 0.031 | 0.79 | 0.019 | 0.48 | 0.62 | 15.87 |
| PTA6     | PTA7*    | PTA8*    | 0.062 | 1.57 | 0.032 | 0.81 | 0.62 | 15.87 |
| PTB6     | PTB7*    | PTB8*    | 0.093 | 2.38 | 0.020 | 0.51 | 0.62 | 15.87 |
| PTC6     | PTC7*    | PTC8*    | 0.125 | 3.17 | 0.027 | 0.69 | 0.62 | 15.87 |
| PTD6     | PTD7     | PTD8*    | 0.187 | 4.74 | 0.035 | 0.89 | 0.62 | 15.87 |
| --       | PTE7     | PTE8     | 0.234 | 5.95 | 0.042 | 1.07 | 0.62 | 15.87 |

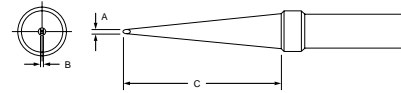

Long Screwdriver

| Cat. No. | Cat. No. | Cat. No. | A     |      | B     |      | C    |       |
|----------|----------|----------|-------|------|-------|------|------|-------|
|          |          |          | in.   | mm   | in.   | mm   | in.  | mm    |
| 600°     | 700°     | 800°     |       |      |       |      |      |       |
| --       | PTJ7     | PTJ8     | 0.031 | 0.79 | 0.012 | 0.30 | 1.00 | 25.40 |
| PTKX6    | --       | --       | 0.046 | 1.17 | 0.030 | 0.76 | 1.00 | 25.40 |
| PTK6     | PTK7*    | PTK8     | 0.046 | 1.19 | 0.026 | 0.66 | 1.00 | 25.40 |
| --       | PTL7     | PTL8     | 0.078 | 1.98 | 0.027 | 0.69 | 1.00 | 25.40 |
| --       | PTM7     | PTM8     | 0.125 | 3.17 | 0.037 | 0.94 | 1.00 | 25.40 |

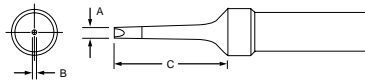

Narrow Screwdriver

| Cat. No. | Cat. No. | Cat. No. | A     |      | B     |      | C    |       |
|----------|----------|----------|-------|------|-------|------|------|-------|
|          |          |          | in.   | mm   | in.   | mm   | in.  | mm    |
| 600°     | 700°     | 800°     |       |      |       |      |      |       |
| PTR6     | PTR7     | PTR8     | 0.062 | 1.58 | 0.044 | 1.12 | 0.62 | 15.87 |

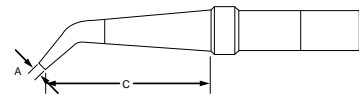

Slotted Bent

| Cat. No. | Cat. No. | Cat. No. | A     |      | B   |    | C    |       |
|----------|----------|----------|-------|------|-----|----|------|-------|
|          |          |          | in.   | mm   | in. | mm | in.  | mm    |
| 600°     | 700°     | 800°     |       |      |     |    |      |       |
| --       | PTZ7     | --       | 0.020 | 0.50 | --  | -- | 1.00 | 25.40 |

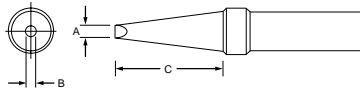

Single Flat

| Cat. No. | Cat. No. | Cat. No. | A     |      | B     |      | C    |       |
|----------|----------|----------|-------|------|-------|------|------|-------|
|          |          |          | in.   | mm   | in.   | mm   | in.  | mm    |
| 600°     | 700°     | 800°     |       |      |       |      |      |       |
| --       | PTAA7    | PTAA8    | 0.062 | 1.57 | 0.040 | 1.42 | 0.62 | 15.87 |
| --       | PTBB7    | PTBB8    | 0.093 | 2.38 | 0.032 | 0.81 | 0.62 | 15.87 |
| --       | PTCC7    | PTCC8    | 0.125 | 3.17 | 0.032 | 0.81 | 0.62 | 15.87 |
| --       | PTDD7    | PTDD8    | 0.187 | 4.74 | 0.032 | 0.81 | 0.62 | 15.87 |

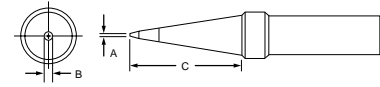

Conical

| Cat. No. | Cat. No. | Cat. No. | A     |      | B     |      | C    |       |
|----------|----------|----------|-------|------|-------|------|------|-------|
|          |          |          | in.   | mm   | in.   | mm   | in.  | mm    |
| 600°     | 700°     | 800°     |       |      |       |      |      |       |
| --       | --       | PTT8     | 0.025 | 0.63 | 0.036 | 0.91 | 0.62 | 15.87 |
| PTP6     | PTP7*    | PTP8*    | 0.031 | 0.79 | 0.012 | 0.30 | 0.62 | 15.87 |

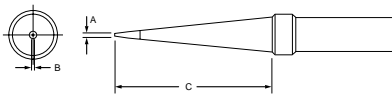

Long Conical

| Cat. No. | Cat. No. | Cat. No. | A     |      | B     |      | C    |       |
|----------|----------|----------|-------|------|-------|------|------|-------|
|          |          |          | in.   | mm   | in.   | mm   | in.  | mm    |
| 600°     | 700°     | 800°     |       |      |       |      |      |       |
| PTS6     | PTS7     | PTS8     | 0.015 | 0.39 | --    | --   | 1.00 | 25.40 |
| PTO6     | PTO7*    | PTO8*    | 0.031 | 0.79 | 0.044 | 1.12 | 1.00 | 25.40 |

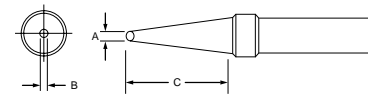

Conical Flat

| Cat. No. | Cat. No. | Cat. No. | A     |      | B     |      | C    |       |
|----------|----------|----------|-------|------|-------|------|------|-------|
|          |          |          | in.   | mm   | in.   | mm   | in.  | mm    |
| 600°     | 700°     | 800°     |       |      |       |      |      |       |
| --       | PTF7     | PTF8     | 0.047 | 1.19 | 0.033 | 0.84 | 0.62 | 15.87 |

\* Indicates available bulk (100 multiples only)

# WDD81V(IL) Digital Shop Air Desoldering Stations



**WDD81VIL** includes: power unit, *DSV80* in-line desoldering pencil, and *AKV* stand.

**DS80** desoldering pencil is available with the *WDD81V* desoldering station and comes with the *AK20* stand.

### The Weller Advantage

- 80 watts of power for faster heat up and better performance even on heavy ground planes and multi-layer boards
- Higher power means less time spent on the PCB and less potential for damaging components
- Vacuum delay feature on the desoldering tool allows the solder to reach the solder collection chamber before the vacuum is shut off to avoid clogging

**Additional Product Features and Benefits:**

- High performance desoldering tool for safely and efficiently removing through hole components from PCB's
- Features digital process control for exact temperature set - gives you control over the process
- Microprocessor circuitry automatically recognizes other Weller soldering accessories and provides the optimal setting for that tool
- Uses fast-response shop air
- WDD81VIL comes with *DSV80* in-line desoldering tool with internal solder collection chamber - ideal for vertical desoldering
- WDD81V comes with *DS80* desoldering pencil with external solder collection chamber - ideal for horizontal desoldering
- ESD safe to protect sensitive components
- Programmable using the optional *WCB1* control module - allows for temperature lock-out (process control), temperature set-back (extended tip life) and °F to °C conversion
- Uses *DS* series desoldering tiplests found on page 16

| Station               | WDD81V and WDD81VIL                    | Pencil               | DS80           | DSV80          |
|-----------------------|--|----------------------|----------------|----------------|
| Voltage               | 120V (input); 24V (output)             | Power Consumption    | 80W            | 80W            |
| Power Consumption     | 95W                                    | Heating Element Type | Nichrome Wound | Nichrome Wound |
| Temperature Range     | 122°F - 842°F (50°C - 450°C)           | Iron Cord Length     | 4 ft. (1.22 m) | 4 ft. (1.22 m) |
| Footprint             | 7.1 X 4.53 X 4 IN (180 X 115 X 101 MM) | Supplied Tiplest     | DS112          | DS112          |
| Weight                | 4.75 lb. (2.16 kg)                     | Iron Stand           | AK20           | AKV            |
| Pump Type             | Compressed Air Converter               |                      |                |                |
| Vacuum Pressure       | 21 in. HG (0.8 Bar)                    |                      |                |                |
| Temperature Stability | +/-10°F (6°C)                          |                      |                |                |
| ESD Safe?             | Yes                                    |                      |                |                |

**Applications:**

- Rework and repair of through hole boards. Lead-free solder applications.



The WDD81V is shown here with the DS80 desoldering pencil.

# WRS10011(2) Digital Self-contained Desoldering Stations



**WRS10011** contains: *WRS1001* control unit, *DSV80* in-line desoldering pencil with internal solder collection chamber, and *AKV* stand.

**WRS10012** contains: *WRS1001* control unit, *DS80* desoldering pencil with external solder collection chamber, and *AK20* stand.

**Additional Product Features and Benefits:**

- Vacuum is generated with a self-contained pump. The pump also generates air should you want to use the optional HAP1 hot air pencil
- Features digital process control for exact temperature set - gives you control over the process
- WRS10011 comes with DSV80 in-line desoldering tool with internal collection chamber - ideal for vertical desoldering
- WRS10012 comes with DS80 desoldering pencil with external solder collection chamber - ideal for horizontal desoldering
- Station also supports Silver Series soldering pencils WSP80 and WMP Micro Pencil for added flexibility
- Programable using the optional WCB1 control module - allows for temperature lock-out (process control), temperature set-back (extended tip life) and °F to °C conversion
- Uses DS series desoldering tiptlets found on page 16
- ESD safe to protect sensitive components

### The Weller Advantage

- 80 watts of power for faster heat up and better performance even on heavy ground planes and multi-layer boards
- Higher power means less time spent on the PCB and less potential for damaging components
- Vacuum delay feature on the desoldering tool allows the solder to reach the solder collection chamber before the vacuum is shut off to avoid clogging

| Station                  | WRS10011 and WRS10012                    | Pencil               | DS80           | DSV80          |
|--------------------------|--|----------------------|----------------|----------------|
| Voltage                  | 120V (input); 24V (output)               | Power Consumption    | 80W            | 80W            |
| Power Consumption        | 175W                                     | Heating Element Type | Nichrome Wound | Nichrome Wound |
| Temperature Range        | 150°F - 980°F (66°C - 511°C)             | Iron Cord Length     | 4 ft. (1.22 m) | 4 ft. (1.22 m) |
| Footprint                | 9.5 X 10.6 X 4.1 IN (241 X 269 X 104 MM) | Supplied Tiptlet     | DS112          | DS112          |
| Weight (Power Unit Only) | 12.9 lb. (5.85 kg)                       | Iron Stand           | AK20           | AKV            |
| Pump Type                | Rotary Vane                              |                      |                |                |
| Air Flow Volume          | 1 l/min. - 10 l/min.                     |                      |                |                |
| Temperature Accuracy     | +/-50°F (30°C)                           |                      |                |                |
| Temperature Stability    | +/-10°F (6°C)                            |                      |                |                |
| ESD Safe?                | Yes                                      |                      |                |                |

**Applications:**

- Rework and repair of through hole boards. Lead-free solder applications.



DSV80 in-line desoldering tool with internal solder collection chamber



DS80 desoldering pencil with external solder collection chamber

# WRS3000V1 (2) Self-contained Solder/Desoldering Stations



**WRS3000V1** comes with *WRS3000* power unit, *DSV80* in-line desoldering pencil, *AKV* stand and sponge, *WSP80* soldering pencil, *WPH80* stand and sponge.



**DS80** desoldering pencil is available with the *WRS3000V2* desoldering station and comes with the *AK20* stand.

### The Weller Advantage

- 80 watts of power for faster heat up and better performance even on heavy ground planes and multi-layer boards
- Higher power means less time spent on the PCB and less potential for damaging components
- Vacuum delay feature on the desoldering tool allows the solder to reach the solder collection chamber before the vacuum is shut off to avoid clogging
- 300 watts of total power over three independently controlled channels (100 watts per channel) plus air and vacuum ports allows you to use up to three 80/100-watt tools simultaneously

**Applications:**

- Rework and repair of mixed technology boards. Lead-free solder applications. Contact removal of IC's and QFP's using specialty SMT tips with the WSP80. Heavy ground planes and multi-layer boards.

**Additional Product Features and Benefits:**

- Built-in pump provides both vacuum for the desoldering tool and air for the optional HAP1 hot air tool
- Microprocessor with digital read-out gives you complete accuracy and reliability
- Temperature set-back can be programmed with the built-in timer from 5 to 60 minutes in 5 minute intervals
- Vacuum for desoldering is activated by a finger switch on the tool
- Lock-out key to maintain process control for set parameters
- Full range of desoldering tiptlets found on page 16
- ESD safe to protect sensitive components

| Station                  | WRS3000V1 (2)                            | Pencil               | WSP80          | DSV80          | DS80           |
|--------------------------|--|----------------------|----------------|----------------|----------------|
| Voltage                  | 120V (input); 24V (output)               | Power Consumption    | 80W            | 80W            | 80W            |
| Power Consumption        | 300W                                     | Heating Element Type | Silver Spool   | Nichrome Wound | Nichrome Wound |
| Temperature Range        | 150°F - 850°F (66°C - 454°C)             | Iron Cord Length     | 4 ft. (1.22 m) | 4 ft. (1.22 m) | 4 ft. (1.22 m) |
| Footprint                | 9.5 X 10.6 X 4.1 IN (241 X 269 X 104 MM) | ESD Safe?            | Yes            | Yes            | Yes            |
| Weight (Power Unit Only) | 22 lb. (10 kg)                           | Standard Tip         | LTB            | DS112          | DS112          |
| Pump Type                | Rotary Vane                              | Iron Stand           | WPH80          | AKV            | AK20           |
| Vacuum Pressure          | 20.7" (526mm) HG                         | Optional Stand       | WPH81          |                |                |
| Air Flow Volume          | 1 l/min. - 10 l/min.                     | For SMT Tips         |                |                |                |
| Temperature Accuracy     | +/-16°F (10°C)                           |                      |                |                |                |
| Temperature Stability    | +/-10°F (6°C)                            |                      |                |                |                |
| ESD Safe?                | Yes                                      |                      |                |                |                |

## DS Series Tiptlets for DS80 and DSV80

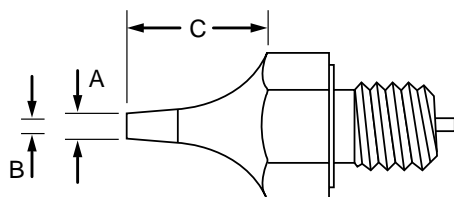

| Cat. No. | A     |      | B     |      | C    |       |
|----------|-------|------|-------|------|------|-------|
|          | in.   | mm   | in.   | mm   | in.  | mm    |
| DS110    | 0.062 | 1.52 | 0.024 | 0.63 | 0.50 | 12.70 |
| DS111    | 0.093 | 2.48 | 0.024 | 0.63 | 0.50 | 12.70 |
| DS112    | 0.078 | 1.93 | 0.031 | 0.91 | 0.50 | 12.70 |
| DS113    | 0.093 | 2.48 | 0.046 | 1.16 | 0.50 | 12.70 |
| DS114    | 0.125 | 3.25 | 0.073 | 1.80 | 0.50 | 12.70 |
| DS116    | 0.093 | 2.48 | 0.043 | 1.14 | 0.75 | 19.05 |
| DS117    | 0.093 | 2.48 | 0.024 | 0.63 | 0.75 | 19.05 |



# WRS3000(S)(ST) Rework and Repair Systems



**WTA50** thermal tweezers and **AK51** stand is available with **WRS3000ST** four function rework station.



**WRS3000S** includes: **WRS3000** control unit, **DSV80** in-line desoldering pencil, **AKV** stand and sponge, **WSP80** soldering pencil, **WPH80** stand and sponge, **HAP1** hot air pencil, **PH60** stand and sponge.

Additional Product Features and Benefits:

- Built-in pump provides both air for the hot air tool and vacuum for the desoldering tool
- Microprocessor with digital read-out gives you complete accuracy and reliability
- Temperature set-back can be programmed with the built-in timer from 5 to 60 minutes in 5 minute intervals
- Air flow for the hot air tool and vacuum for desoldering are activated by a finger switch on the tools
- Lock-out key to maintain process control for set parameters
- Full range of soldering tips (page 9), desoldering tiptlets (page 16), hot air nozzles (page 21), and thermal tweezers tips (page 21) are available
- Special ionizing circuit assures that hot air is static free to protect sensitive components

### The Weller Advantage

- 300 watts of total power over three independently controlled channels (100 watts per channel) plus air and vacuum ports allows you to use up to three 100-watt tools simultaneously
- Vacuum delay feature on the desoldering tool allows the solder to reach the solder collection chamber before the vacuum is shut off to avoid clogging

Applications:

- Production, rework, and repair of through hole and surface mount boards. Contact removal of IC's and QFP's using specialty SMT tips. Applications requiring non-contact hot air. Heavy ground planes and multi-layer boards. Lead-free solder applications



Non-contact soldering with the **HAP1** hot air pencil.



Desoldering a SMT component using the **WTA50** thermal tweezers.



The **DSV80** 80-watt desoldering tool is perfect for desoldering through-hole components.

# WRS4000 Four-function Rework and Repair System



## The Weller Advantage

- 400 watts of total power over four independently controlled channels (100 watts per channel) plus air and vacuum ports allows you to use up to four 100-watt tools simultaneously: soldering, desoldering, hot air, and thermal tweezers
- Vacuum delay feature on the desoldering tool allows the solder to reach the solder collection chamber before the vacuum is shut off to avoid clogging

**WRS4000** includes: *WRS3000* control unit, *WRS1001* control unit, *WSP80* soldering pencil, *WPH80* stand and sponge, *DSV80* in-line desoldering pencil, *AKV* stand and sponge, *WTA50* thermal tweezers, *AK51* stand and sponge, *HAP1* hot air pencil, *PH60* stand and sponge.

### Applications:

- Production, rework, and repair of through hole and SMT boards. Contact removal of IC's and QFP's using specialty SMT tips. Applications requiring non-contact hot air. Heavy ground planes and multi-layer boards. Lead-free solder applications.

### Additional Product Features and Benefits:

- Built-in pump provides both air for the hot air tool and vacuum for the desoldering tool
- Microprocessor with digital read-out gives you complete accuracy and reliability
- Temperature set-back can be programmed with the built-in timer from 5 to 60 minutes in 5 minute intervals
- Air flow for the hot air tool and vacuum for desoldering are activated by a finger switch on the tools
- Lock-out key to maintain process control for set parameters
- Full range of soldering tips (page 9), desoldering tiptlets (page 16), hot air nozzles (page 21), and thermal tweezers tips (page 21) are available
- Special ionizing circuit assures that hot air is static free to protect sensitive components

# WRS5000 Five-function Rework and Repair System

**The Weller Advantage**

- 400 watts of total power over four independently controlled channels (100 watts per channel) plus air and vacuum ports allows you to use up to six tools simultaneously: soldering, desoldering, hot air, and thermal tweezers, dispensing, and vacuum pickup
- Vacuum delay feature on the desoldering tool allows the solder to reach the solder collection chamber before the vacuum is shut off to avoid clogging



**WRS5000** includes: *WRS3000* and *WRS2000* control units, *WSP80* soldering pencil, *WPH80* stand and sponge, *DSV80* in-line desoldering pencil, *AKV* stand and sponge, *HAP1* hot air pencil, *PH60* stand and sponge, *WTA50* thermal tweezers, *AK51* stand and sponge, vacuum pencil, syringe and needle, vacuum pencil and syringe stand

**Additional Product Features and Benefits:**

- Built-in pump provides both air for the hot air tool and vacuum for the desoldering tool
- Microprocessor with digital read-out gives you complete accuracy and reliability
- Temperature set-back can be programmed with the built-in timer from 5 to 60 minutes in 5 minute intervals
- Air flow for the hot air tool and vacuum for desoldering are activated by a finger switch on the tools
- Includes a vacuum pickup wand for handling components
- Dispensing and vacuum pickup wand utilize fast-acting shop air
- Timer on the front panel allows dispensing in timed intervals
- Lock-out key to maintain process control for set parameters
- Full range of soldering tips (page 9), desoldering tiplests (page 16), hot air nozzles (page 21), and thermal tweezers tips (page 21) are available
- Special ionizing circuit assures that hot air is static free to protect sensitive components

**Applications:**

- Production, rework, and repair of through hole and SMT boards. Applications requiring non-contact hot air. Heavy ground planes and multi-layer boards. Solder paste, epoxy, silicone, and potting compound dispensing applications. Lead-free solder applications.



The WSP80 in use on a surface mount PCB.



Non-contact soldering with the HAP1 hot air pencil.



The WTA50 is perfect for removing Melf's from a SMT board.

# WRS7000 Seven-function Rework and Repair System



### The Weller Advantage

- Over 1200 watts of total power over five independently controlled channels (100 watts per channel) plus air and vacuum ports allows you to use up to seven tools simultaneously: soldering, desoldering, small hot air pencil (100W), large hot air pencil (700W), thermal tweezers, dispensing, and vacuum pickup
- Vacuum delay feature on the desoldering tool allows the solder to reach the solder collection chamber before the vacuum is shut off to avoid clogging

**WRS7000** includes: *WRS3000* and *WRS2000* and *WHA2000* control units, *WSP80* soldering pencil, *WPH80* stand and sponge, *DSV80* in-line desoldering pencil, *AKV* stand and sponge, *HAP1* hot air pencil, *PH60* stand and sponge, *WTA50* thermal tweezers, *AK51* stand and sponge, vacuum pencil, syringe and needle, vacuum pencil and syringe stand.

#### Additional Product Features and Benefits:

- Built-in pump provides both air for the hot air tool and vacuum for the desoldering tool
- Microprocessor with digital read-out gives you complete accuracy and reliability
- Temperature set-back can be programmed with the built-in timer from 5 to 60 minutes in 5 minute intervals
- Air flow for the hot air tool and vacuum for desoldering are activated by a finger switch on the tools
- Self-contained hot air station with large hot air pencil. Allows you to easily rework and repair large IC's and QFP's
- Large hot air pencil has built-in vacuum pickup - eliminates guesswork when chip is ready for removal
- Includes a vacuum pickup wand for handling components
- Dispensing and vacuum pickup wand utilize fast-acting shop air
- Timer on the front panel allows dispensing in timed intervals
- Lock-out key to maintain process control for set parameters
- Full range of soldering tips (page 9), desoldering tiplests (page 16), hot air nozzles (page 21), and thermal tweezers tips (page 21) are available
- Special ionizing circuit assures that hot air is static free to protect sensitive components

#### Applications:

- Production, rework, and repair of through hole and SMT boards. Applications requiring non-contact hot air. Heavy ground planes and multi-layer boards. Solder paste, epoxy, silicone, and potting compound dispensing applications. Lead-free solder applications



A SMT quad tip is used to desolder a quad flat pack with the WSP80 soldering pencil.



Hot air is directed onto the leads of the QFP component.



Through hole rework with the DSV80

# Nozzles for HAP1 Small Hot Air Pencil

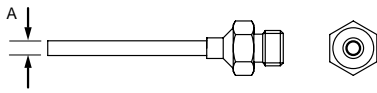

Round

| Cat. No.   | A     |      | B   |    |
|------------|-------|------|-----|----|
|            | in.   | mm   | in. | mm |
| 0058727823 | 0.031 | 0.80 | --  | -- |
| 0058727821 | 0.047 | 1.20 | --  | -- |
| 0058727787 | 0.098 | 2.50 | --  | -- |
| 0058727822 | 0.118 | 3.00 | --  | -- |

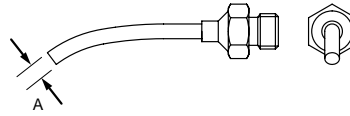

Round Bent

| Cat. No.   | A     |      | B   |    |
|------------|-------|------|-----|----|
|            | in.   | mm   | in. | mm |
| 0058727786 | 0.079 | 2.00 | --  | -- |

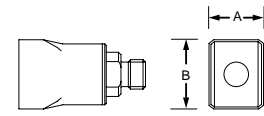

2-Sides Heated

| Cat. No.   | A     |       | B     |       |
|------------|-------|-------|-------|-------|
|            | in.   | mm    | in.   | mm    |
| 0058727782 | 0.394 | 10.00 | 0.512 | 13.00 |
| 0058727781 | 0.394 | 10.00 | 0.591 | 15.00 |
| 0058727784 | 0.394 | 10.00 | 0.709 | 18.00 |
| 0058727779 | 0.413 | 10.50 | 0.413 | 10.50 |

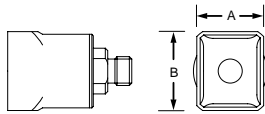

4-Sides Heated

| Cat. No.   | A     |       | B     |       |
|------------|-------|-------|-------|-------|
|            | in.   | mm    | in.   | mm    |
| 0058727777 | 0.236 | 6.00  | 0.256 | 6.50  |
| 0058727778 | 0.236 | 6.00  | 0.354 | 9.00  |
| 0058727780 | 0.394 | 10.00 | 0.591 | 15.00 |
| 0058727783 | 0.492 | 12.50 | 0.591 | 15.00 |
| 0058727785 | 0.709 | 18.00 | 0.709 | 18.00 |

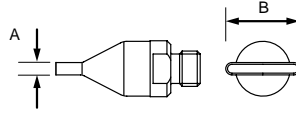

Flat

| Cat. No.   | A     |      | B     |       |
|------------|-------|------|-------|-------|
|            | in.   | mm   | in.   | mm    |
| 0058727774 | 0.059 | 1.50 | 0.315 | 8.00  |
| 0058727784 | 0.059 | 1.50 | 0.394 | 10.00 |
| 0058727779 | 0.059 | 1.50 | 0.472 | 12.00 |

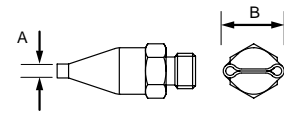

Dual

| Cat. No.   | A     |      | B     |       |
|------------|-------|------|-------|-------|
|            | in.   | mm   | in.   | mm    |
| 0058727775 | 0.059 | 1.50 | 0.315 | 8.00  |
| 0058727776 | 0.059 | 1.50 | 0.394 | 10.00 |

# WT Series Tips for WTA50 Thermal Tweezers

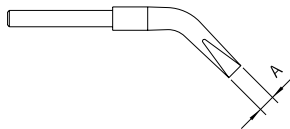

WTA1

| Cat. No.   | A     |      |
|------------|-------|------|
|            | in.   | mm   |
| 0054414199 | 0.039 | 1.00 |

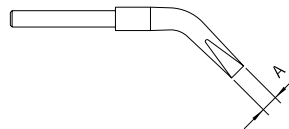

WTA2

| Cat. No.   | A     |      |
|------------|-------|------|
|            | in.   | mm   |
| 0054414699 | 0.118 | 3.00 |

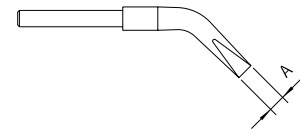

WTA3

| Cat. No.   | A     |      |
|------------|-------|------|
|            | in.   | mm   |
| 0054414799 | 0.236 | 6.00 |

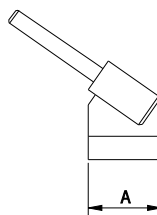

WTA4

| Cat. No.   | A     |       |
|------------|-------|-------|
|            | in.   | mm    |
| 0054414399 | 0.492 | 12.50 |

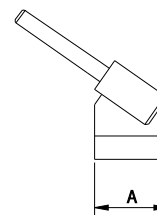

WTA5

| Cat. No.   | A     |       |
|------------|-------|-------|
|            | in.   | mm    |
| 0054414499 | 0.728 | 18.50 |

# WQB3000 BGA/QFP Rework Station



WQB3000

Additional Product Features and Benefits:

**Base Unit:**

- The unit features a two head system for component placement and hot air desoldering
- The two heads operate on sliding arms, which are controlled by pneumatic cylinders
- The control electronics and pneumatic unit are integrated into the rear housing
- LED's on the back of the housing panel indicate four process states: top heater, bottom heater, desoldering, and cooling
- RS-232 interface for data input unit or PC control. An easy-to-use PC software interface for input using a computer, rather than the supplied control box, is included

**Soldering and Placement Heads:**

- The connection for the hot air nozzle temperature sensor is in the soldering head to give you the highest possible hot air temperature accuracy
- Precision linear feed for vertical adjustment, approximately 3.2" (80 mm) stroke
- A continuously adjustable depth stop prevents the head from dropping onto the board
- The head mechanisms are pneumatically damped to give you finer control over the movement of the soldering and placement heads

**Soldering Head Only:**

- A vacuum lift built into the hot air nozzle allows for the automatic desoldering of components. The vacuum tube can be continuously adjusted in height with a 10 mm adjustment range
- Theta rotation of the soldering head in a range of -5° to 95°
- A swiveling halogen light is mounted near the soldering and placement heads in order to illuminate the work space
- A wide range of easily interchangeable hot air nozzles are available and are listed on page 23

## The Weller Advantage

- Excellent process control including below-board infrared pre-heating, precisely regulated and metered heat applied to the component, and electronic digital regulation of the air flow rate
- All process steps can be programmed and saved as rework profiles on the digital data input unit or a PC
- The WQB3000 utilizes the patented Weller mini-template system for the placement of components on the circuit board

**Placement Head Only:**

- A vacuum receptacle is activated by a button on the front of the placement head
  - A reducer insert for the vacuum receptacle is provided for smaller components
- Bottom Heater:**
- Table is equipped with a high temperature long wavelength infrared ceramic lamp for efficient bottom pre-heat of the PCB
  - The bottom pre-heater is divided into two zones: The 400-watt inner zone is 5" x 5". The 1600-watt outer zone is 10.6" x 10.6"
  - The temperature is regulated by thermocouples integrated in the central heater lamp

**Circuit Board Holder:**

- Able to hold circuit boards with a minimum width of 1.2" (30 mm) and a maximum width of 19.5" (495 mm) and unlimited length
- After positioning the board, a precision drive in the X and Y directions allows you to achieve exact positioning. The adjustment range is ± 0.40" (10 mm) with adjustment precision of ± 0.002" (0.05 mm). The controls for the precision adjustment are located on the sides of the table

**Data Input Unit:**

- Parameters for each process step, including bottom heater temperature, soldering head temperature, airflow rate, process time, and cooling time can be programmed
- A LCD display with background lighting gives you a clear, easy-to-read display
- A key switch is provided to lockout against unauthorized use
- Up to 30 profiles can be stores in the data input unit

| Station                          | WQB3000                                    |
|----------------------------------|--|
| Dimensions (L x W x H)           | 25.6 x 23.6 x 19.7 IN (650 x 600 x 500 mm) |
| Input Voltage                    | 230 - 240V, 50-60 Hz                       |
| Power Consumption-Soldering Head | 700W                                       |
| Power Consumption-Bottom Heater  | 400W (Inner) & 1600W (Outer)               |
| Temperature Range-Soldering Head | 122°F - 752°F (50°C - 400°C)               |
| Temperature Accuracy             | +/-59°F (15°C)                             |
| Air Flow Rate                    | 5 - 50 l/Min.                              |
| Total Weight                     | 80 lb. (36 kg)                             |

Applications:

- Rework and repair of SMT array packages including ceramic, and plastic, BGA's, micro BGA's, Chip Scale Packages, PLCC's, and QFP's. Multi-layer boards and ground planes.



The WQB3000 is ready to desolder a BGA component.



Parameters for each process can be programmed into the data input unit.



BGA placement is easy using the patented Weller® placement templates.

# Nozzles and Templates for WQB3000

| Component       | Matrix  | Component Body Size | Pitch (mm) | Nozzle No.  | Nozzle I.D. (mm) | Nozzle O.D. (mm) | Template No. |
|-----------------|---------|---------------------|------------|-------------|------------------|------------------|--------------|
| Micro BGA       | 23 X 23 | 12 X 12             | 0.50S      | 0058747904  | 13.5 X 13.5      | 14.3 X 14.3      | 0058754945   |
| Micro BGA       | 29 X 29 | 15 X 15             | 0.50       | 0058747935  | 15.5 X 15.5      | 16.5 X 16.5      | 0058747932   |
| Micro BGA       | 6 X 10  | 8 X 10.2            | 0.75       | 0058747961  | 8.5 X 10.6       | 9.5 X 11.6       | 0058747963   |
| Micro BGA       | 8 X 8   | 8.1 X 8.1           | 0.75       | 0058747945Δ | 8.5 X 8.5        | 9.5 X 9.5        | 0058754838Δ  |
| Micro BGA       | 9 X 8   | 7.6 X 16.4          | 0.75       | 0058747833  | 18 X 18          | 20 X 20          | 0058747899   |
| Micro BGA       | 10 X 10 | 10 X 10             | 0.80       | 0058747848  | 12 X 12          | 13 X 13          | 0058747958   |
| Micro BGA       | 13 X 13 | 12 X 12             | 0.80       | 0058747904  | 13.5 X 13.5      | 14.3 X 14.3      | 0058747959Δ  |
| Micro BGA       | 14 X 14 | 13 X 13             | 0.80       | 0058747904  | 13.5 X 13.5      | 14.3 X 14.3      | 0058747934Δ  |
| Micro BGA       | 15 X 15 | 13 X 13             | 0.80       | 0058747904  | 13.5 X 13.5      | 14.3 X 14.3      | 0058747973Δ  |
| Micro BGA       | 18 X 18 | 16 X 16             | 0.80       | 0058747833  | 18 X 18          | 20 X 20          | 0058747964   |
| Micro BGA       | 19 X 19 | 16 X 16             | 0.80       | 0058747833  | 18 X 18          | 20 X 20          | 0058754841   |
| Micro BGA       | 6 X 8   | 8 X 10.2            | 0.80       | 0058747961  | 8.5 X 10.6       | 9.5 X 11.6       | 0058754763   |
| Micro BGA       | 7 X 7   | 7 X 7               | 0.80       | 0058747945Δ | 8.5 X 8.5        | 9.5 X 9.5        | 005874762Δ   |
| Micro BGA       | 8 X 8   | 8 X 8               | 0.80       | 0058747945Δ | 8.5 X 8.5        | 9.5 X 9.5        | 0058747956Δ  |
| Micro BGA       | 9 X 9   | 8 X 8               | 0.80       | 0058747945Δ | 8.5 X 8.5        | 9.5 X 9.5        | 0058747954Δ  |
| BGA 209         | 11 X 19 | 14 X 22             | 1.00       | 0058747977  | 15.5 X 23.5      | 16.5 X 24.5      | 0058754847   |
| BGA             | 12 X 12 | 13 X 13             | 1.00       | 0058747904  | 13.5 X 13.5      | 14.3 X 14.3      | 0058747929   |
| BGA 196         | 14 X 14 | 15 X 15             | 1.00       | 0058747935  | 15.5 X 15.5      | 16.5 X 16.5      | 0058747930   |
| BGA             | 16 X 16 | 17 X 17             | 1.00       | 0058747833  | 18 X 18          | 20 X 20          | 0058747931   |
| BGA 484         | 22 X 22 | 23 X 23             | 1.00       | 0058747764  | 25 X 25          | 27 X 27          | 0058754760   |
| BGA             | 24 X 24 | 25 X 25             | 1.00       | 0058747850Δ | 27 X 27          | 29 X 29          | 0058754779Δ  |
| BGA 676         | 26 X 26 | 27 X 27             | 1.00       | 0058747927  | 29 X 29          | 31 X 31          | 0058754777   |
| BGA             | 29 X 29 | 31 X 31             | 1.00       | 0058747906  | 33 X 33          | 35 X 35          | 0058754761   |
| BGA 900         | 30 X 30 | 31 X 31             | 1.00       | 0058747906  | 33 X 33          | 35 X 35          | 0058754849   |
| BGA             | 34 X 34 | 35 X 35             | 1.00       | 0058747753  | 37 X 37          | 39 X 39          | 0058754850   |
| BGA 680         | 39 X 39 | 40 X 40             | 1.00       | 0058747874  | 42 X 42          | 44 X 44          | 0058747987   |
| BGA 540         | 32 X 32 | 44 X 44             | 1.27       | 0058747763  | 46 X 46          | 48 X 48          | 0058747778   |
| BGA 119         | 7 X 7   | 14 X 22             | 1.27       | 0058747977  | 15.5 X 23.5      | 16.5 X 24.5      | 0058747974   |
| BGA 357/361     | 19 X 19 | 25 X 25             | 1.27F      | 0058747850Δ | 27 X 27          | 29 X 29          | 0058747781Δ  |
| BGA 624         | 24 X 26 | 35 X 35             | 1.27F      | 0058747753  | 37 X 37          | 39 X 39          | 0058754848   |
| BGA 192/217     | 17 X 17 | 23 X 23             | 1.27P      | 0058747764  | 25 X 25          | 27 X 27          | 0058747861   |
| BGA 256/272/292 | 20 X 20 | 27 X 27             | 1.27P      | 0058747927  | 29 X 29          | 31 X 31          | 0058747966   |
| BGA 304         | 23 X 23 | 31 X 31             | 1.27P      | 0058747906  | 33 X 33          | 35 X 35          | 0058747911   |
| BGA 388         | 26 X 26 | 35 X 35             | 1.27P      | 0058747753  | 37 X 37          | 39 X 39          | 0058747779   |
| BGA 432         | 31 X 31 | 40 X 40             | 1.27P      | 0058747874  | 42 X 42          | 44 X 44          | 0058747859   |
| BGA 560         | 33 X 33 | 43 X 43             | 1.27P      | 0058747763  | 46 X 46          | 48 X 48          | 0058747897   |
| BGA 313         | 25 X 25 | 35 X 35             | 1.27S      | 0058747753  | 37 X 37          | 39 X 39          | 0058747894   |
| BGA 225         | 15 X 15 | 27 X 27             | 1.5F       | 0058747927  | 29 X 29          | 31 X 31          | 0058747782Δ  |

| Component | Matrix | Component Body Size | Pitch (mm) | Nozzle Catalog No. | Nozzle I.D. (mm) | Nozzle O.D. (mm) | Template Catalog No. |
|-----------|--------|---------------------|------------|--------------------|------------------|------------------|----------------------|
| PLCC 20   | -      | 10 X 10             | 1.27       | 0058747848         | 12 X 12          | 13 X 13          | 0058754808           |
| PLCC 28   | -      | 12.5 X 12.5         | 1.27       | 0058747904         | 13.5 X 13.5      | 14.3 X 14.3      | 0058754809           |
| PLCC 44   | -      | 17.5 X 17.5         | 1.27       | 0058747833         | 18 X 18          | 20 X 20          | 0058754810Δ          |
| PLCC 52   | -      | 20.2 X 20.2         | 1.27       | 0058754770Δ        | 21 X 21          | 23 X 23          | 0058754811Δ          |
| PLCC 68   | -      | 25.2 X 25.2         | 1.27       | 0058747850Δ        | 27 X 27          | 29 X 29          | 0058754812Δ          |

**Notes:**

(Δ) Denotes Make To Order. Contact us for a quote and lead-time.

Quad Flat Packs can be reworked using hot air nozzles found on page 28 (adapter #0058759970 required).

**Pitch Key:**

**P** = Perimeter Matrix

**S** = Staggered Matrix

**F** = Full Matrix

# WAD101 Digital Shop Air Hot Air Station



**The Weller Advantage**

- Features digital temperature control with easy to read LED display for fast and accurate temperature set of the hot air
- Programmable using the optional WCB1 control module. Allows for temperature lockout for process control, temperature setback and °F to °C conversion

**WAD101** includes: *HAP1* hot air pencil, *PH60* stand and sponge.

**Applications:**

- Rework and repair of SMT boards. Sensitive applications requiring non-contact hot air. Some ground planes and multi-layer boards.

**Additional Product Features and Benefits:**

- Air flow is adjustable using knob on the side of the power unit
- Compact design is ideal for soldering, desoldering, and rework of SMT components
- Uses fast acting shop air or compressed nitrogen
- Air flow is actuated by a finger switch on the hot air pencil
- Full range of hot air nozzles is available on page 21
- ESD safe to protect sensitive components

| Station                  | WAD101   | Pencil               | HAP1   |
|--------------------------|--|----------------------|--|
| Voltage                  | 120V (input); 24V (output)                     | Power Consumption    | 100W   |
| Power Consumption        | 100W   | Heating Element Type | Nichrome Wound, fiberglass and ceramic insulated |
| Temperature Range        | 122°F - 1022°F (50°C - 550°C)                  | Iron Cord Length     | 4 ft. (1.22 m)                                   |
| Footprint                | 4 1/2 X 5 15/16 X 3 5/8 IN (114 X 150 X 91 MM) | ESD Safe?            | Yes  |
| Weight (Power Unit Only) | 3.9 lb. (1.78 kg)                              | Standard Nozzle      | 0058727821                                       |
| Air Flow Volume          | 1 l/min. - 6 l/min.                            | Iron Stand           | KH27 (0051502799)                                |
| Temperature Accuracy     | ± 50°F - (30°C )                               |                      |  |
| ESD Safe?                | Yes  |                      |  |



# WRS1001 Digital Self-contained Hot Air Station

## The Weller Advantage

- Features digital temperature control with easy to read LED display for fast and accurate temperature set of the hot air
- Programmable using the optional WCB1 control module. Allows for temperature lockout for process control, temperature setback and °F to °C conversion



**WRS1001** includes: *HAP1* 100 watt hot air pencil, *PH60* stand and sponge.

### Additional Product Features and Benefits:

- Internal rotary pump means no need for shop air
- Air flow is adjustable digital electronics on the front panel
- Compact design is ideal for soldering, desoldering, and rework of SMT components
- Air flow is actuated by a finger switch on the hot air pencil
- Full range of hot air nozzles is available on page 21
- Special ionizing circuit assures that hot air is static free to protect sensitive components

| Station                  | WRS1001                                  |
|--------------------------|--|
| Voltage                  | 120V (input); 24V (output)               |
| Power Consumption        | 175W                                     |
| Temperature Range        | 150°F - 980°F (66°C - 511°C)             |
| Footprint                | 9.5 X 10.6 X 4.1 IN (241 X 269 X 104 MM) |
| Weight (Power Unit Only) | 12.9 lb. (5.85 kg)                       |
| Pump Type                | Rotary Vane                              |
| Air Flow Volume          | 1 l/min. - 10 l/min.                     |
| Temperature Accuracy     | +/-50°F (30°C)                           |
| Temperature Stability    | +/-10°F (6°C)                            |
| ESD Safe?                | Yes                                      |

### Applications:

- Rework and repair of SMT boards. Sensitive applications requiring non-contact hot air. Some ground planes and multi-layer boards. Heat shrink tubing.



The *HAP1* desoldering a component.

# WHA500 Digital Self-contained Hot Air Station

Available January 2003.



WHA500

## The Weller Advantage

- Digital control electronics displays both the set and read temperatures.
- A sensor in the heating element reads the hot air temperature and displays it on the digital display
- Gives you maximum control over the process to avoid thermal stress on sensitive components.

### Applications:

- Rework and repair of SMT boards. Sensitive applications requiring non-contact hot air. Most ground plane and multi-layer board applications

### Additional Product Features and Benefits:

- Air flow volume is adjustable using the knob on the front panel
- Air temperature is adjustable to accommodate most SMT rework applications
- A quiet, reliable, trouble-free internal pump generates the air flow – no need for an external air source
- A one-minute cool-down mode is activated when the power switch is turned off, which reduces nozzle temperature prior to nozzle change
- The air delivery tube is flexible to prevent the air flow from being interrupted
- A carry handle is mounted on the top of the housing for portability
- The WHA500 is compatible with the current Weller hot air nozzles
- The air flow is antistatic, so sensitive components are not harmed
- A complete range of nozzles is available – see page 28

| Station              | WHA500   |
|----------------------|--|
| Input Voltage        | 120V   |
| Output Voltage       | 120V   |
| Power Consumption    | 350W   |
| Temperature Range    | 122°F - 1022°F (50°C - 550°C)                    |
| Footprint            | 6 5/8 X 8 1/8 X 3 7/8 in. (168 X 206 X 98 mm)    |
| Weight               | 9 lb. (4.1 kg)                                   |
| Air Flow Volume      | 3 l/min – 30 l/min.                              |
| Temperature Accuracy | +/- 86°F (55°C)                                  |
| ESD Safe?            | Yes  |
| Heating Element Type | Nichrome wound, Fiberglass and ceramic insulated |
| Standard Nozzle      | No nozzle included - order separately            |

# WHA2000 Analog Self-contained Hot Air Station

## The Weller Advantage

- The hand piece and nozzle have built in vacuum pick up. Simply activate the vacuum with the foot pedal and lift the component off of the board with the nozzle when the solder reflows



WHA2000

### Additional Product Features and Benefits:

- An internal turbine generates the air flow - no need for shop air
- High performance 750-watt hand piece can handle more demanding rework applications
- Electronic control allows you to precisely control the hot air temperature which helps avoid thermal stress on the target component
- Vacuum for component pickup is activated by the foot switch
- Complete range of nozzles is available on page 28
- Special ionizing circuit assures that hot air is static free to protect sensitive components

| Station                  | WHA2000  |
|--------------------------|--|
| Voltage                  | 120V (input); 120V (output)                      |
| Power Consumption        | 820W   |
| Temperature Range        | 122°F - 1022°F (50°C - 550°C)                    |
| Weight (Power Unit Only) | 20.35 lb. (9.26 kg)                              |
| Pump Type                | Turbine  |
| Air Flow Volume          | 10 l/min. - 50 l/min.                            |
| Temperature Accuracy     | +/-86°F (55°C)                                   |
| ESD Safe?                | Yes  |
| Heating Element Type     | Nichrome wound, fiberglass and ceramic insulated |
| Standard Nozzle          | No nozzle included - order separately            |

### Applications:

- Rework and repair of SMT boards. Sensitive applications requiring non-contact hot air. Most ground planes and multi-layer boards.



**Step 1:** Hot air is directed onto the leads of the QFP component.



**Step 2:** The nozzle is lowered onto the component to effect reflow and engage the component to the vacuum pick-up.



**Step 3:** The component is lifted off the board using the built-in vacuum pick-up.

# Nozzles for WHA500 and WHA2000

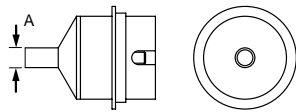

Round (No Vacuum)

| Cat. No.            | A     |       | B   |    |
|---------------------|-------|-------|-----|----|
|                     | in.   | mm    | in. | mm |
| 0058736881          | 0.098 | 2.50  | --  | -- |
| 0058736867          | 0.157 | 4.00  | --  | -- |
| 0058736870          | 0.276 | 7.00  | --  | -- |
| 0058736836 $\Delta$ | 0.453 | 11.50 | --  | -- |

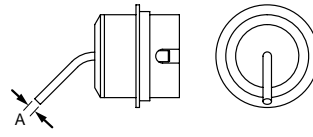

Round Bent (No Vacuum)

| Cat. No.   | A     |      | B   |    |
|------------|-------|------|-----|----|
|            | in.   | mm   | in. | mm |
| 0058736882 | 0.059 | 1.50 | --  | -- |

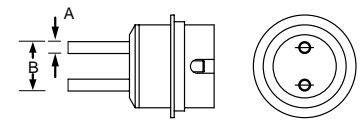

Round Dual (No Vacuum)

| Cat. No.   | A     |      | B     |      |
|------------|-------|------|-------|------|
|            | in.   | mm   | in.   | mm   |
| 0058736883 | 0.098 | 2.50 | 0.374 | 9.50 |

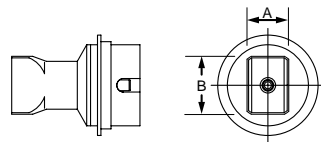

2-Sides Heated

| Cat. No.            | A     |       | B     |       |
|---------------------|-------|-------|-------|-------|
|                     | in.   | mm    | in.   | mm    |
| 0058736840          | 0.583 | 4.80  | 0.846 | 21.50 |
| 0058736842          | 0.394 | 10.00 | 0.551 | 14.00 |
| 0058736843          | 0.421 | 10.70 | 0.421 | 10.70 |
| 0058736841          | 0.472 | 12.00 | 0.748 | 19.00 |
| 0058736876 $\Delta$ | 0.472 | 12.00 | 1.063 | 27.00 |
| 0058736857 $\Delta$ | 1.496 | 38.00 | 1.496 | 38.00 |
| 0058736873 $\Delta$ | 1.575 | 40.00 | 1.575 | 40.00 |

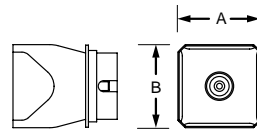

4-Sides Heated

| Cat. No.            | A     |       | B     |       |
|---------------------|-------|-------|-------|-------|
|                     | in.   | mm    | in.   | mm    |
| 0058736839          | 0.433 | 11.00 | 0.433 | 11.00 |
| 0058736818          | 0.583 | 14.80 | 0.583 | 14.80 |
| 0058736814          | 0.709 | 18.00 | 0.709 | 18.00 |
| 0058736807          | 0.807 | 20.50 | 0.807 | 20.50 |
| 0058736804          | 1.024 | 26.00 | 1.024 | 26.00 |
| 0058736833          | 1.260 | 32.00 | 1.260 | 32.00 |
| 0058736891          | 1.417 | 36.00 | 1.417 | 36.00 |
| 0058736890 $\Delta$ | 1.693 | 43.00 | 1.693 | 43.00 |
| 0058736838          | 0.394 | 10.00 | 0.571 | 14.50 |
| 0058736880 $\Delta$ | 0.472 | 12.00 | 0.945 | 24.00 |
| 0058736837          | 0.512 | 13.00 | 0.610 | 15.50 |
| 0058736892 $\Delta$ | 0.551 | 14.00 | 1.063 | 27.00 |
| 0058750721          | 0.669 | 17.00 | 0.925 | 23.50 |
| 0058736877 $\Delta$ | 0.669 | 17.00 | 1.142 | 29.00 |
| 0058736998 $\Delta$ | 0.906 | 23.00 | 1.398 | 35.50 |
| 0058736999 $\Delta$ | 1.201 | 30.50 | 1.909 | 48.50 |
| 0058736858 $\Delta$ | 1.260 | 32.00 | 1.732 | 44.00 |
| 0058750709 $\Delta$ | 1.496 | 38.00 | 1.909 | 48.50 |
| 0058750714 $\Delta$ | 1.496 | 38.00 | 2.402 | 61.00 |

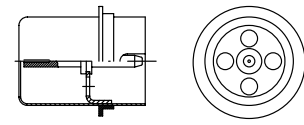

Measuring

| Cat. No.            | A   |    | B   |    |
|---------------------|-----|----|-----|----|
|                     | in. | mm | in. | mm |
| 0058736875 $\Delta$ | N/A |    | N/A |    |

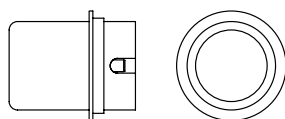

Adapter for Hakko Nozzles

| Cat. No.   | A   |    | B   |    |
|------------|-----|----|-----|----|
|            | in. | mm | in. | mm |
| 0058750722 | N/A |    | N/A |    |

**Notes:**

( $\Delta$ ) Denotes Make To Order. Contact us for a quote and lead-time.

| Cat. No.   | Page | Cat. No.   | Page                        | Cat. No. | Page                   | Cat. No.  | Page                   | Cat. No.  | Page                     |
|------------|------|------------|-----------------------------|----------|------------------------|-----------|------------------------|-----------|--------------------------|
| 0054414199 | .21  | 0058747906 | .23                         | ETT      | .5                     | MT607     | .11                    | PTE8      | .13                      |
| 0054414399 | .21  | 0058747911 | .23                         | ETU      | .5                     | MT608     | .11                    | PTF7      | .13                      |
| 0054414499 | .21  | 0058747927 | .23                         | ETV      | .5                     | MT609     | .11                    | PTF8      | .13                      |
| 0054414699 | .21  | 0058747929 | .23                         | HAP1     | 17, 18, 19, 20, 24, 25 | MT610     | .11                    | PTH6      | .13                      |
| 0054414799 | .21  | 0058747930 | .23                         | LT1      | .9                     | MT611     | .11                    | PTH7      | .13                      |
| 0058727774 | .21  | 0058747931 | .23                         | LT1L     | .9                     | MT613     | .11                    | PTH8      | .13                      |
| 0058727775 | .21  | 0058747932 | .23                         | LT1LX    | .9                     | MT614     | .11                    | PTJ7      | .13                      |
| 0058727776 | .21  | 0058747934 | .23                         | LT1S     | .9                     | MT617     | .11                    | PTJ8      | .13                      |
| 0058727777 | .21  | 0058747935 | .23                         | LT1SLX   | .9                     | MT620     | .11                    | PTK6      | .13                      |
| 0058727778 | .21  | 0058747945 | .23                         | LT1X     | .9                     | NT1       | .7                     | PTK7      | .13                      |
| 0058727779 | .21  | 0058747954 | .23                         | LT4W     | .9                     | NT1S      | .7                     | PTK8      | .13                      |
| 0058727780 | .21  | 0058747956 | .23                         | LT4X     | .9                     | NT1X      | .7                     | PTKX6     | .13                      |
| 0058727781 | .21  | 0058747958 | .23                         | LTA      | .9                     | NT4       | .7                     | PTL7      | .13                      |
| 0058727782 | .21  | 0058747959 | .23                         | LTAS     | .9                     | NT6       | .7                     | PTL8      | .13                      |
| 0058727783 | .21  | 0058747961 | .23                         | LTAX     | .9                     | NTA       | .7                     | PTM7      | .13                      |
| 0058727784 | .21  | 0058747963 | .23                         | LTB      | .9                     | NTAX      | .7                     | PTM8      | .13                      |
| 0058727785 | .21  | 0058747964 | .23                         | LTC      | .9                     | NTB       | .7                     | PTO6      | .13                      |
| 0058727786 | .21  | 0058747966 | .23                         | LTCs     | .9                     | NTC       | .7                     | PTO7      | .13                      |
| 0058727787 | .21  | 0058747973 | .23                         | LTD      | .9                     | NTD       | .7                     | PTO8      | .13                      |
| 0058727821 | .21  | 0058747974 | .23                         | LTF      | .9                     | NTGW      | .7                     | PTP6      | .13                      |
| 0058727822 | .21  | 0058747977 | .23                         | LTH      | .9                     | NTH       | .7                     | PTP7      | .13                      |
| 0058727823 | .21  | 0058747987 | .23                         | LTHX     | .9                     | NTK       | .7                     | PTP8      | .13                      |
| 0058736804 | .28  | 0058750709 | .28                         | LTK      | .9                     | NTSMT01   | .7                     | PTR6      | .13                      |
| 0058736807 | .28  | 0058750714 | .28                         | LTKN     | .9                     | NTSMT02   | .7                     | PTR7      | .13                      |
| 0058736814 | .28  | 0058750721 | .28                         | LTL      | .9                     | NTSMT03   | .7                     | PTR8      | .13                      |
| 0058736818 | .28  | 0058750722 | .28                         | LTM      | .9                     | NTSMT04   | .7                     | PTS6      | .13                      |
| 0058736833 | .28  | 0058754760 | .23                         | LTS      | .9                     | NTSMT05   | .7                     | PTS7      | .13                      |
| 0058736836 | .28  | 0058754761 | .23                         | LTSMT01  | .9                     | NTSMT06   | .7                     | PTS8      | .13                      |
| 0058736837 | .28  | 0058754762 | .23                         | LTSMT02  | .9                     | NTSMT07   | .7                     | PTT8      | .13                      |
| 0058736838 | .28  | 0058754763 | .23                         | LTSMT03  | .9                     | NTSMT08   | .7                     | PTZ7      | .13                      |
| 0058736839 | .28  | 0058754770 | .23                         | LTSMT04  | .9                     | NTSMT09   | .7                     | PU120T    | .12                      |
| 0058736840 | .28  | 0058754777 | .23                         | LTSMT05  | .9                     | NTSMT10   | .7                     | TC201T    | .12                      |
| 0058736841 | .28  | 0058754779 | .23                         | LTSMT06  | .9                     | NTSMT11   | .7                     | WAD101    | .24                      |
| 0058736842 | .28  | 0058754808 | .23                         | LTSMT07  | .9                     | NTSMT12   | .7                     | WDD81V    | .14                      |
| 0058736843 | .28  | 0058754809 | .23                         | LTSMT08  | .9                     | NTSMT13   | .7                     | WDD81VIL  | .14                      |
| 0058736857 | .28  | 0058754810 | .23                         | LTSMT09  | .9                     | NTSMT14   | .7                     | WES51     | .3                       |
| 0058736858 | .28  | 0058754811 | .23                         | LTSMT10  | .9                     | NTSMT15   | .7                     | WES51PU   | .3                       |
| 0058736867 | .28  | 0058754812 | .23                         | LTSMT11  | .9                     | NTSMT16   | .7                     | WESD51    | .4                       |
| 0058736870 | .28  | 0058754838 | .23                         | LTSMT12  | .9                     | NTSMT17   | .7                     | WESD51PU  | .4                       |
| 0058736873 | .28  | 0058754841 | .23                         | LTSMT13  | .9                     | NTSMT18   | .7                     | WHA2000   | .20, 27                  |
| 0058736875 | .28  | 0058754847 | .23                         | LTSMT14  | .9                     | NTSMT19   | .7                     | WHA500    | .26                      |
| 0058736876 | .28  | 0058754848 | .23                         | LTSMT15  | .9                     | NTSMT20   | .7                     | WHP81     | .6                       |
| 0058736877 | .28  | 0058754849 | .23                         | LTSMT16  | .9                     | NTSMT21   | .7                     | WMP       | .6                       |
| 0058736880 | .28  | 0058754850 | .23                         | LTSMT17  | .9                     | NTSMT22   | .7                     | WMPH      | .6                       |
| 0058736881 | .28  | 0058754945 | .23                         | LTSMT18  | .9                     | PES51     | .3, 4                  | WPH80     | .17, 18, 19, 20          |
| 0058736882 | .28  | AK20       | .14, 15, 16                 | LTSMT19  | .9                     | PH1201ESD | .12                    | WPH81     | .8                       |
| 0058736883 | .28  | AK51       | .17, 18, 19, 20             | LTSMT20  | .9                     | PH50      | .3, 4                  | WQB3000   | .22                      |
| 0058736890 | .28  | AKV        | 14, 15, 16, 17, 18, 19, 20  | LTSMT21  | .9                     | PH60      | 17, 18, 19, 20, 24, 25 | WRS1001   | .15, 18, 25              |
| 0058736891 | .28  | DS80       | .14, 15, 16                 | LTSMT22  | .9                     | PTA6      | .13                    | WRS10011  | .15                      |
| 0058736892 | .28  | DSV80      | .14, 15, 16, 17, 18, 19, 20 | MT1205   | .11                    | PTA7      | .13                    | WRS10012  | .15                      |
| 0058736998 | .28  | ETA        | .3, 4, 5                    | MT1500   | .10                    | PTA8      | .13                    | WRS2000   | .19, 20                  |
| 0058736999 | .28  | ETAA       | .5                          | MT1501   | .10                    | PTAA7     | .13                    | WRS3000   | 16, 17, 18, 19, 20       |
| 0058747753 | .23  | ETAB       | .5                          | MT1502   | .10                    | PTAA8     | .13                    | WRS3000S  | .17                      |
| 0058747763 | .23  | ETBB       | .5                          | MT202    | .11                    | PTB6      | .13                    | WRS3000ST | .17                      |
| 0058747764 | .23  | ETC        | .5                          | MT203    | .11                    | PTB7      | .13                    | WRS3000V1 | .16                      |
| 0058747778 | .23  | ETCC       | .5                          | MT204    | .11                    | PTB8      | .13                    | WRS3000V2 | .16                      |
| 0058747779 | .23  | ETDD       | .5                          | MT211    | .11                    | PTBB7     | .13                    | WRS4000   | .18                      |
| 0058747781 | .23  | ETD        | .5                          | MT212    | .11                    | PTBB8     | .13                    | WRS5000   | .19                      |
| 0058747782 | .23  | ETDD       | .5                          | MT220    | .11                    | PTC6      | .13                    | WRS7000   | .20                      |
| 0058747833 | .23  | ETH        | .5                          | MT221    | .11                    | PTC7      | .13                    | WSD161    | .8                       |
| 0058747848 | .23  | ETJ        | .5                          | MT301    | .11                    | PTC8      | .13                    | WSD81     | .8                       |
| 0058747850 | .23  | ETK        | .5                          | MT302    | .11                    | PTCC7     | .13                    | WSD81PU   | .8                       |
| 0058747859 | .23  | ETKN       | .5                          | MT303    | .11                    | PTCC8     | .13                    | WSL       | .6                       |
| 0058747861 | .23  | ETL        | .5                          | MT601    | .11                    | PTD6      | .13                    | WSL2      | .6                       |
| 0058747874 | .23  | ETM        | .5                          | MT602    | .11                    | PTD7      | .13                    | WSL2PU    | .6                       |
| 0058747894 | .23  | ETO        | .5                          | MT603    | .11                    | PTD8      | .13                    | WSLPU     | .6                       |
| 0058747897 | .23  | ETP        | .5                          | MT604    | .11                    | PTDD7     | .13                    | WSP80     | 6, 8, 16, 17, 18, 19, 20 |
| 0058747899 | .23  | ETR        | .5                          | MT605    | .11                    | PTDD8     | .13                    | WTA50     | .17, 18, 19, 20          |
| 0058747904 | .23  | ETS        | .5                          | MT606    | .11                    | PTE7      | .13                    | WTCPT     | .12                      |







**AIRETOOL®**  
**APEX® • BUCKEYE®**  
**CAMPBELL® • CLECO®**  
**COOPER AUTOMATION™ • CRESCENT®**  
**DGD® • DOLER® • DOTCO® • EREM®**  
**GARDNER-DENVER® • GARDOTRANS™**  
**GETA™ • KAHNETICS® • LUFKIN®**  
**• MASTER POWER® • METRONIX™**  
**• NICHOLSON® • PLUMB® • H.K. PORTER®**  
**• QUACKENBUSH™ • RECOULES™ • ROTOR™**  
**• UTICA® • WELLER® • WIRE-WRAP®**  
**WISS® • XCELITE®**

**CooperTools**  
P.O. Box 728  
Apex, NC 27502-0728

Northeast  
Phone: 919-362-7540  
Fax: 800-854-5137

South  
Phone: 919-362-7541  
Fax: 800-854-5139

Midwest  
Phone: 919-362-7542  
Fax: 800-854-5138

West Coast (Southwest)  
Phone: 919-362-1709  
Fax: 800-546-7312

All other USA inquires  
Fax: 800-423-6175

[www.coopertools.com](http://www.coopertools.com)